

**METRIC**  
DIMENSIONS ARE IN METRES  
AND/OR MILLIMETRES  
UNLESS OTHERWISE SHOWN



HWY 11  
CONT NO  
GWP No759-93-00

STIRLING CREEK RD INTERCHANGE  
E-N RAMP CENTRELINE  
STATION 10+030 TO 10+270  
BOREHOLE LOCATIONS AND SOIL STRATA

SHEET



THURBER ENGINEERING LTD.  
THURBER

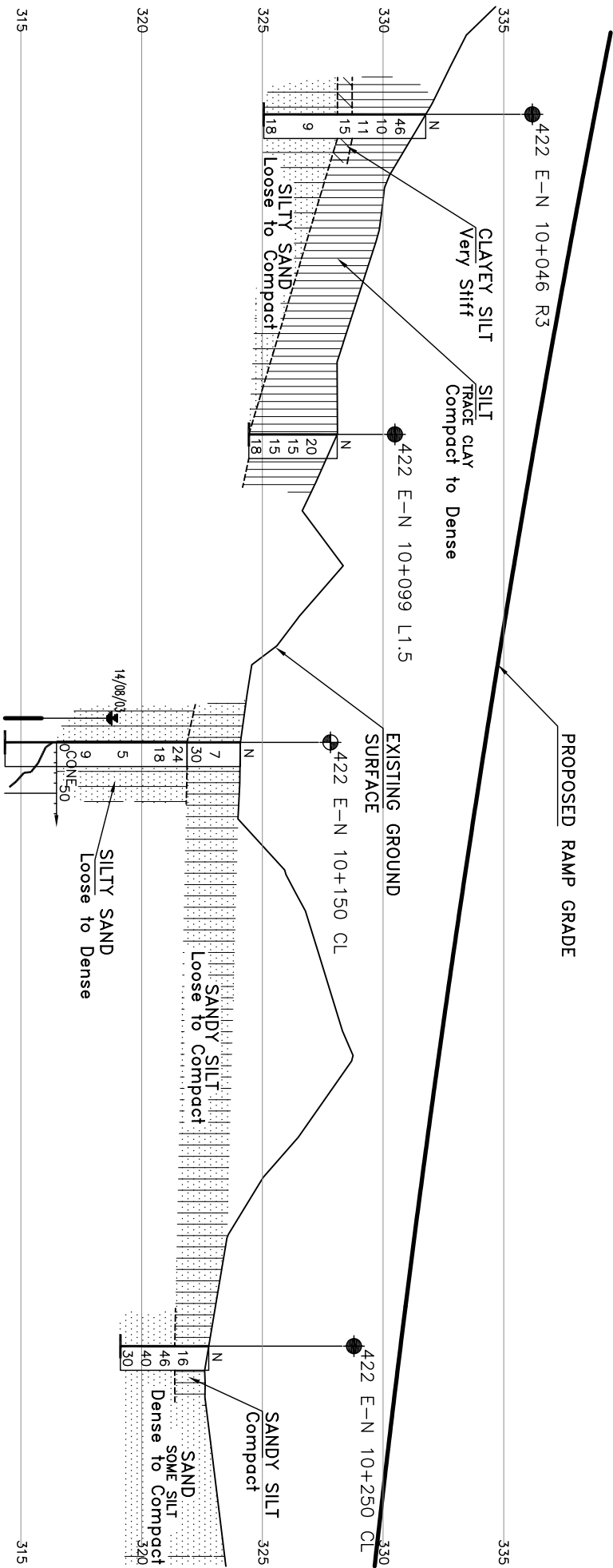
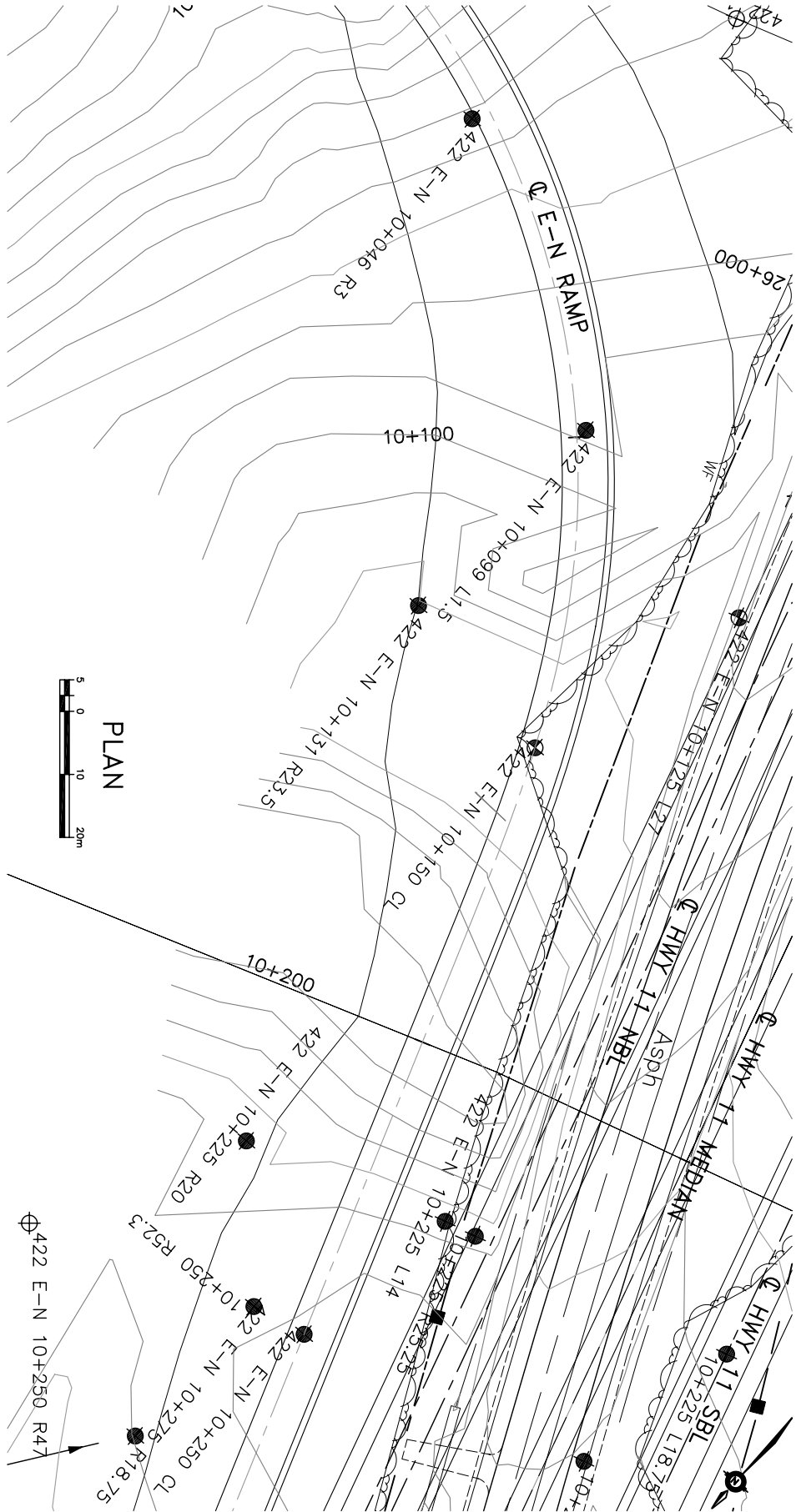
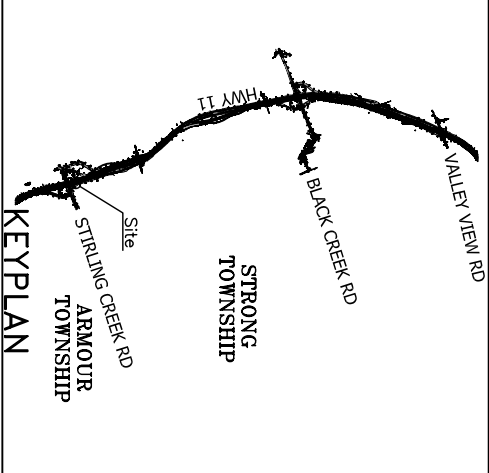

LEGEND		
	Bore Hole	
	Dynamic Cone Penetration Test (cone)	
	Bore Hole & Cone	
	Blows/0.3m (Std pen Test, 475J/blow)	
	Blows/0.3m (60° Cone, 475J/blow)	
	Pressure, Hydraulic	
	WL in Piezometer at Time of Investigation (Date)	
	Head Artesian Water	
	Piezometer	
	90% of Drilling	
	Rock Quality Designation (RQD)	
	Auger Refusal	
	Cone Refusal	
NO	STATION	OFFSET FROM MEDIAN CL
422 E-N 10+046 R3	10+046	R3
422 E-N 10+099 L1.5	10+099	L1.5
422 E-N 10+125 L27	10+125	L27
422 E-N 10+131 R23.5	10+131	R23.5
422 E-N 10+150 CL	10+150	0
422 E-N 10+225 L14	10+225	L14
422 E-N 10+225 R20	10+225	R20
422 E-N 10+250 CL	10+250	0
422 E-N 10+250 R47	10+250	R47
422 E-N 10+275 L18.75	10+275	L18.75
422 E-N 10+275 R18.75	10+275	R18.75

NOTE

The boundaries between soil strata have been established only at Bore Hole locations. Between Bore Holes the boundaries are assumed from geological evidence.

PROFILE OF E-N RAMP



DRAWING NOT TO BE SCALED  
100 mm ON ORIGINAL DRAWING

REVISIONS			
NOV 04	SP	ISSUED AS DRAFT FOR REVIEW	
DATE	BY	DESCRIPTION	DATE
DESIGN SKP	CHK SKP	CODE	LOAD
DRAWN IT/WW/CHK PJR	SITE	STRUCT	SCHEME
			DWG B4