

METRIC
DIMENSIONS ARE IN METRES
AND/OR MILLIMETRES
UNLESS OTHERWISE SHOWN

CONT No
GWP No 6370-14-00

HIGHWAY 17
DINORWIC LAKE
CULVERT REPLACEMENT
BOREHOLE LOCATIONS AND SOIL STRATA

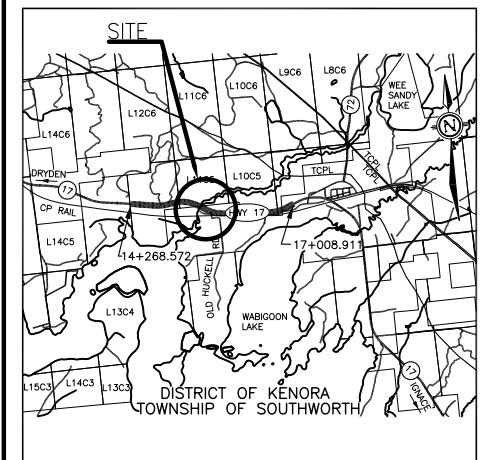

KEYPLAN

LEGEND

| | |
|------|---------------------------------------|
| | Borehole |
| | Borehole and Cone |
| N | Blows /0.3m (Std Pen Test, 475J/blow) |
| CONE | Blows /0.3m (60° Cone, 475J/blow) |
| PH | Pressure, Hydraulic |
| | Water Level |
| | Head Artesian Water |
| | Piezometer |
| 90% | Rock Quality Designation (RQD) |
| A/R | Auger Refusal |

| NO | ELEVATION | NORTHING | EASTING |
|--------|-----------|--------------|-------------|
| DL16-1 | 369.9000 | 5506147.4624 | 338812.1063 |
| DL16-2 | 381.7000 | 5506121.9001 | 338807.3617 |
| DL16-3 | 381.8000 | 5506114.9475 | 338791.8920 |
| DL16-4 | 371.3000 | 5506085.6527 | 338787.8143 |
| | | | |
| | | | |
| | | | |
| | | | |
| | | | |
| | | | |

-NOTES-

- The boundaries between soil strata have been established only at Borehole locations. Between Boreholes the boundaries are assumed from geological evidence.
- This drawing is for subsurface information only. Surface details and features are for conceptual illustration.
- MTM Zone 16 co-ordinate system used to obtain borehole Northings and Eastings.

GEOCRIS No. 52F-55

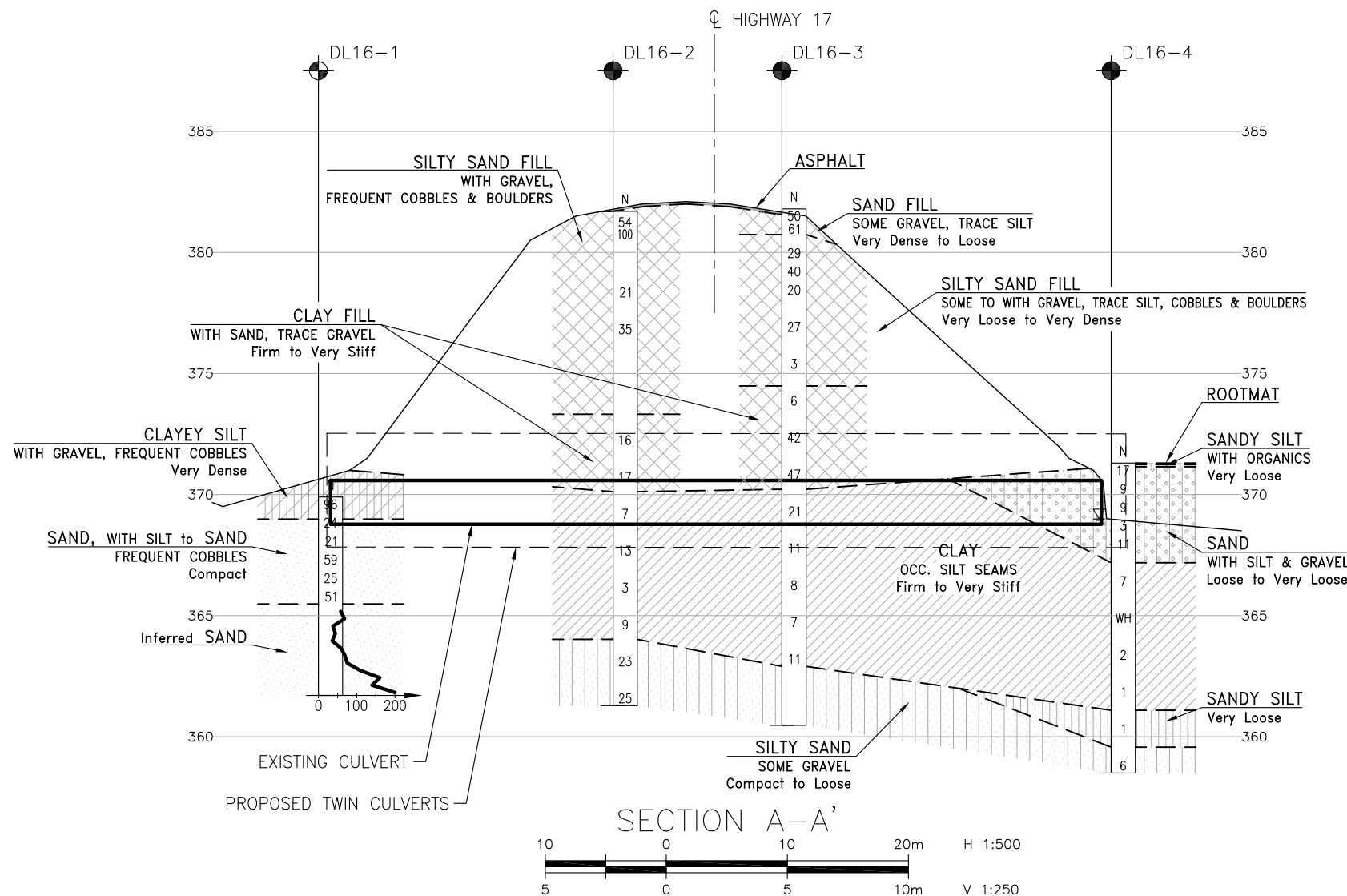

| REVISIONS | DATE | BY | DESCRIPTION |
|-----------|------|----|-------------|
| | | | |
| | | | |
| | | | |
| | | | |
| | | | |
| | | | |
| | | | |
| | | | |
| | | | |

| | | | | | | |
|--------|-----|---------|------|--------|------|----------|
| DESIGN | SBP | CHK - | CODE | LOAD | DATE | OCT 2017 |
| DRAWN | MFA | CHK SBP | SITE | STRUCT | DWG | 1 |