

#59-F-242-C

W.P. 263-59

FOLEYET -

CHAPLEAU RD.

EAST SITE ABUTMENT

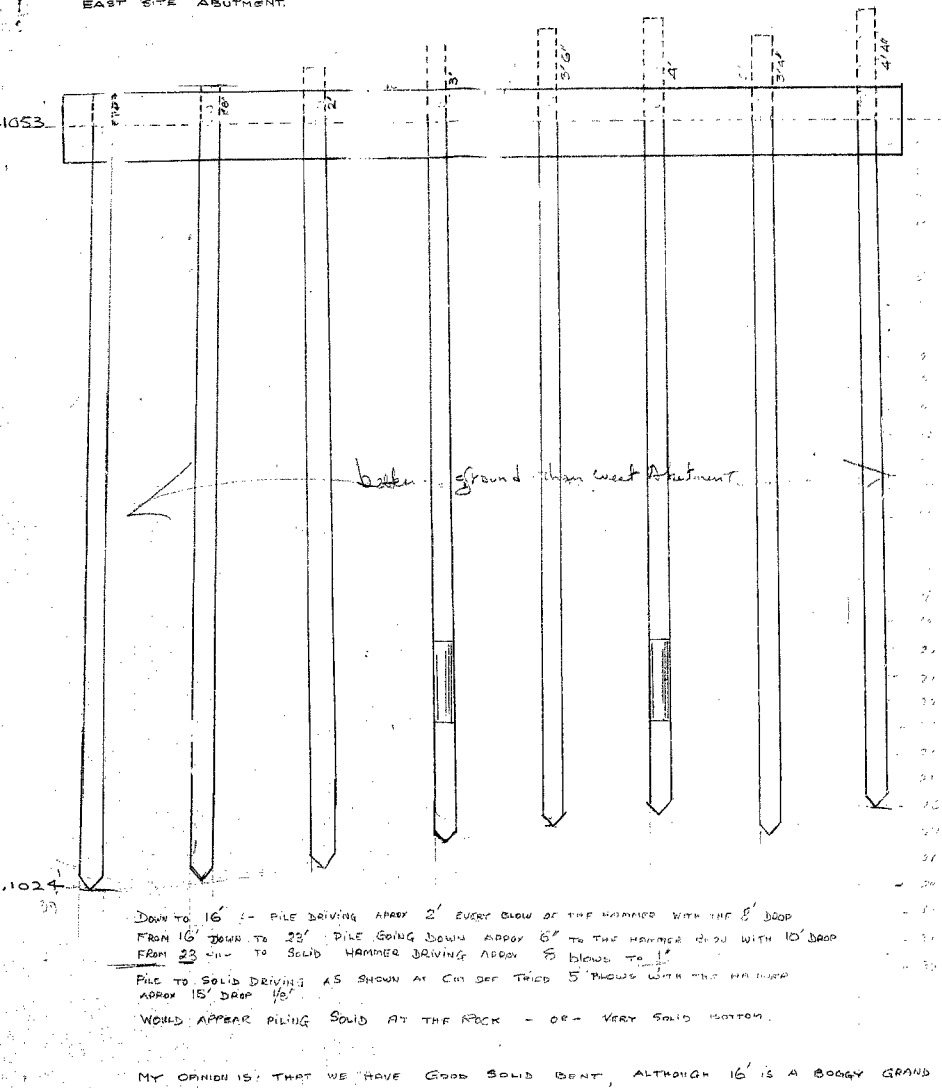

HQWY. GEN. FOREMAN *Roy A. Waugh*

WEST SITE ABUTMENT

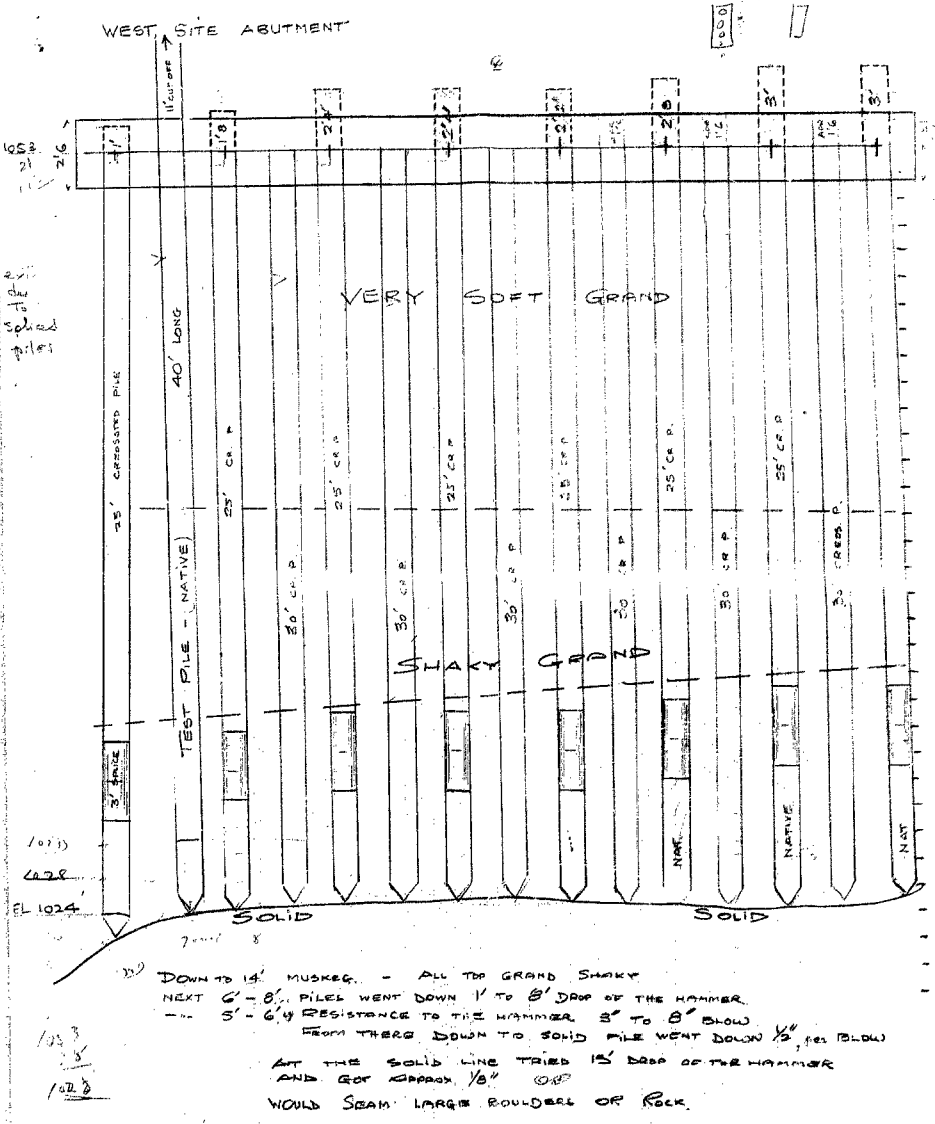

HQWY. GEN. FOREMAN *Roy A. Waugh*

EAST PIER H-PIILING

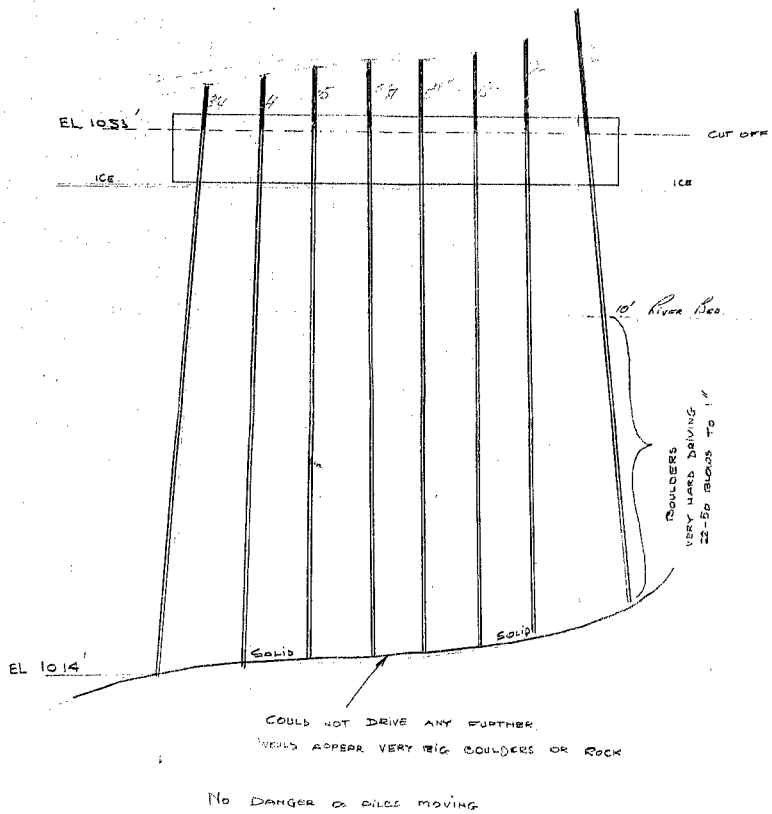

HQWY. GEN. FOREMAN *Roy A. Waugh*

WEST PIER H-PIILING

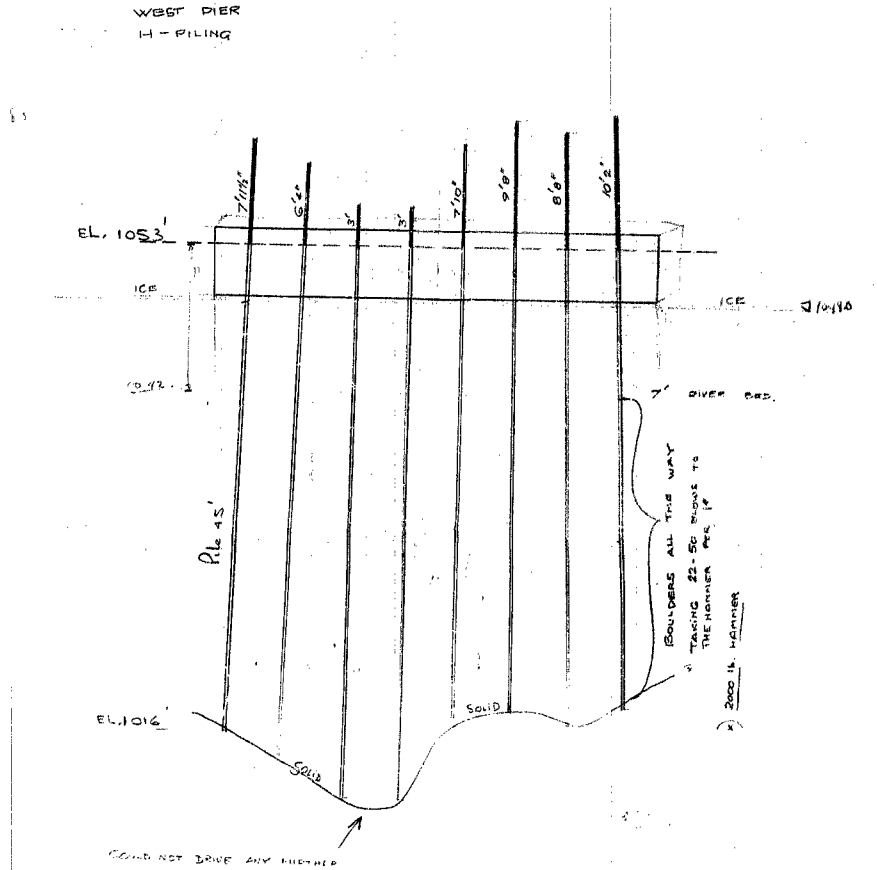

HQWY. GEN. FOREMAN *Roy A. Waugh*

APPROXIMATE LOCATION OF WELL
ON FARMERS' PROPERTY

B.M. #1 20' HD. 0+00
ELEV. 1062.46

550 A

72'

120'

150'

180'

210'

240'

270'

300'

330'

360'

390'

420'

450'

480'

510'

540'

570'

600'

630'

660'

690'

720'

750'

780'

810'

840'

870'

900'

930'

960'

990'

1020'

1050'

1080'

1110'

1140'

1170'

1200'

1230'

1260'

1290'

1320'

1350'

1380'

1410'

1440'

1470'

1500'

1530'

1560'

1590'

1620'

1650'

1680'

1710'

1740'

1770'

1800'

1830'

1860'

1890'

1920'

1950'

1980'

2010'

2040'

2070'

2100'

2130'

2160'

2190'

2220'

2250'

2280'

2310'

2340'

2370'

2400'

2430'

2460'

2490'

2520'

2550'

2580'

2610'

2640'

2670'

2700'

2730'

2760'

2790'

2820'

2850'

2880'

2910'

2940'

2970'

3000'

3030'

3060'

3090'

3120'

3150'

3180'

3210'

3240'

3270'

3300'

3330'

3360'

3390'

3420'

3450'

3480'

3510'

3540'

3570'

3600'

3630'

3660'

3690'

3720'

3750'

3780'

3810'

3840'

3870'

3900'

3930'

3960'

3990'

4020'

4050'

4080'

4110'

4140'

4170'

4200'

4230'

4260'

4290'

4320'

4350'

4380'

4410'

4440'

4470'

4500'

4530'

4560'

4590'

4620'

4650'

4680'

4710'

4740'

4770'

4800'

4830'

4860'

4890'

4920'

4950'

4980'

5010'

5040'

5070'

5100'

5130'

5160'

5190'

5220'

5250'

5280'

5310'

5340'

5370'

5400'

5430'

5460'

5490'

5520'

5550'

5580'

5610'

5640'

5670'

5700'

5730'

5760'

5790'

5820'

5850'

5880'

5910'

5940'

5970'

6000'

6030'

6060'

6090'

6120'

6150'

6180'

6210'

6240'

6270'

6300'

6330'

6360'

6390'

6420'

6450'

6480'

6510'

6540'

6570'

6600'

6630'

6660'

6690'

6720'

6750'

6780'

6810'

6840'

6870'

6900'

6930'

6960'

6990'

7020'

7050'

7080'

7110'

7140'

7170'

7200'

7230'

7260'

7290'

7320'

7350'

7380'

7410'

7440'

7470'

7500'

7530'

7560'

7590'

7620'

7650'

7680'

7710'

7740'

7770'

7800'

7830'

7860'

7890'

7920'

7950'

7980'

8010'

8040'

8070'

8100'

8130'

8160'

8190'

8220'

8250'

8280'

8310'

8340'

8370'

8400'

8430'

8460'

8490'

8520'

8550'

8580'

8610'

8640'

8670'

DISTRICT OF SUDBURY
TOWNSHIP OF FOLEYET
CON 2 LOT 20

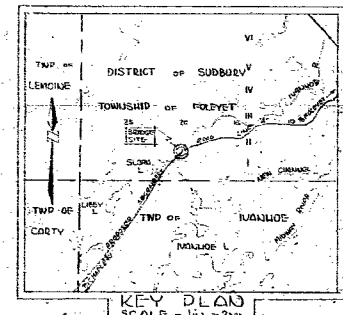
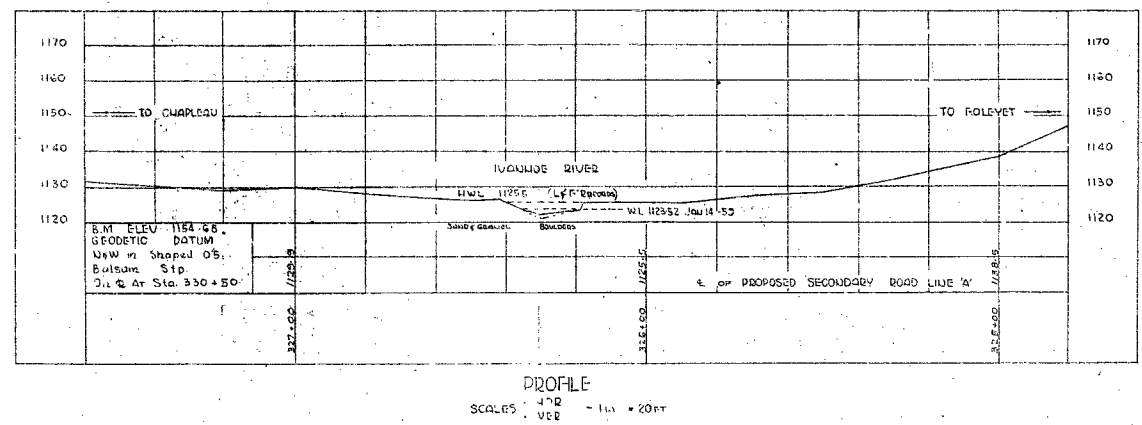
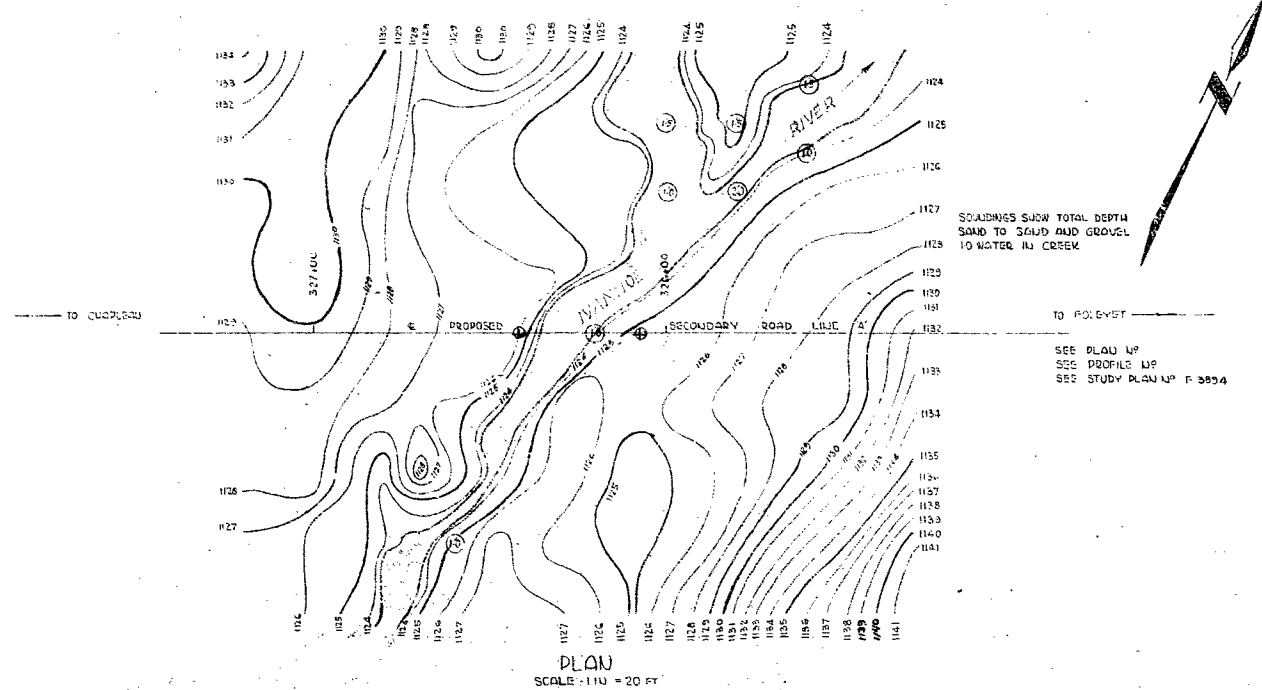

FOLEYET
GBM N° 2290 EL 1062977
CITY bridge over Ivanhoe River at mileage 0.4 northwest of station. Table in top of ballast wall on no-thrust concrete abutment, 4 feet from southwest end of wall.

WP 262-59

DEPARTMENT OF HIGHWAYS - ONTARIO	
PLANNING & DESIGN BRANCH	
DISTRICT N° 14	
PROPOSED CROSSING	
AT	
IVANHOE RIVER	
AND	
PROPOSED SECONDARY ROAD LINE 'A'	
TO CHAPLEAU	
FOLEYET TO	
LOT 20 CON. 2	
TOWNSHIP OF FOLEYET DISTRICT OF SUDBURY	
BRIDGE SITE	
SURVEY BY Chief of Party Supervisor	APPROVED Director of Planning & Design
DRAWN BY Draftsman Supervisor	SCALE - AS SHOWN DATE OF SURVEY JAN. 1959 DATE OF PLAN FEB. 1959
CHECKED BY Draftsman Supervisor	PLAN - 1 of 1 PLAN - F-3579-1

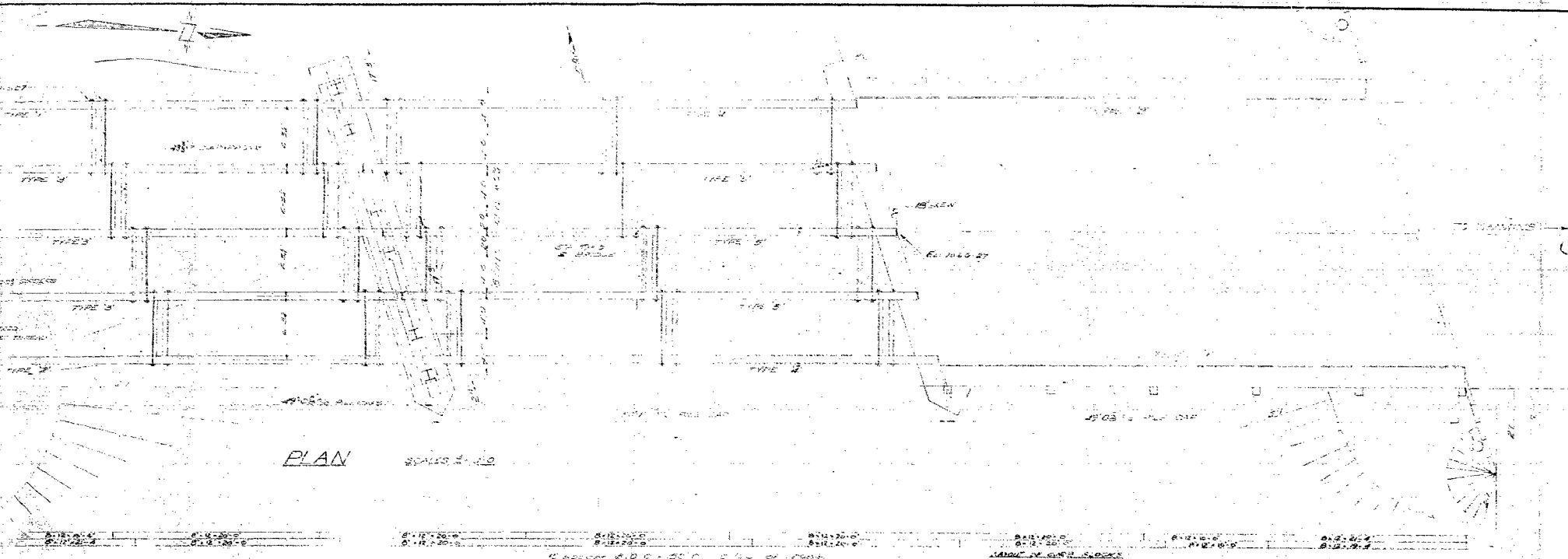

PLAN
SCALE 1" = 40'

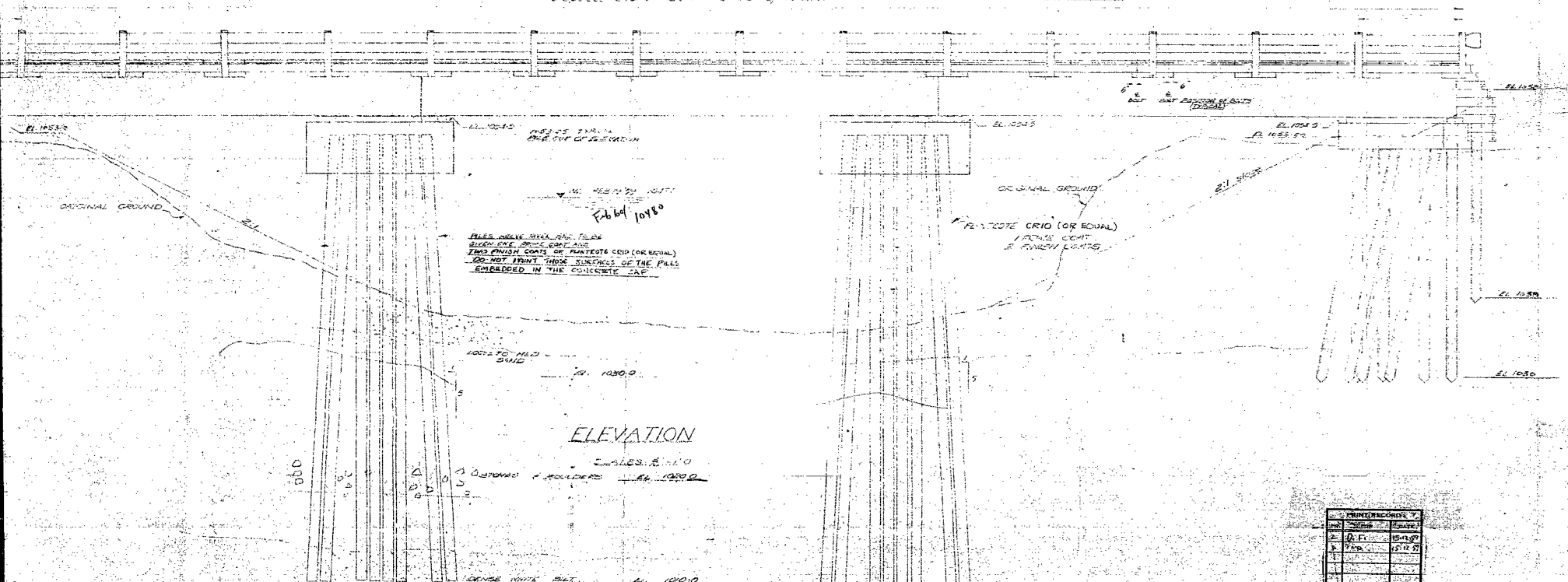

ELEVATION
SCALE 1" = 40'

NOTES:
1. THE BRIDGE SHALL BE CONSTRUCTED TO THE DESIGN ELEVATIONS SHOWN ON THIS DRAWING.
2. THE BRIDGE SHALL BE CONSTRUCTED TO THE DESIGN ELEVATIONS SHOWN ON THIS DRAWING.
3. THE BRIDGE SHALL BE CONSTRUCTED TO THE DESIGN ELEVATIONS SHOWN ON THIS DRAWING.
4. THE BRIDGE SHALL BE CONSTRUCTED TO THE DESIGN ELEVATIONS SHOWN ON THIS DRAWING.
5. THE BRIDGE SHALL BE CONSTRUCTED TO THE DESIGN ELEVATIONS SHOWN ON THIS DRAWING.
6. THE BRIDGE SHALL BE CONSTRUCTED TO THE DESIGN ELEVATIONS SHOWN ON THIS DRAWING.
7. THE BRIDGE SHALL BE CONSTRUCTED TO THE DESIGN ELEVATIONS SHOWN ON THIS DRAWING.
8. THE BRIDGE SHALL BE CONSTRUCTED TO THE DESIGN ELEVATIONS SHOWN ON THIS DRAWING.
9. THE BRIDGE SHALL BE CONSTRUCTED TO THE DESIGN ELEVATIONS SHOWN ON THIS DRAWING.
10. THE BRIDGE SHALL BE CONSTRUCTED TO THE DESIGN ELEVATIONS SHOWN ON THIS DRAWING.

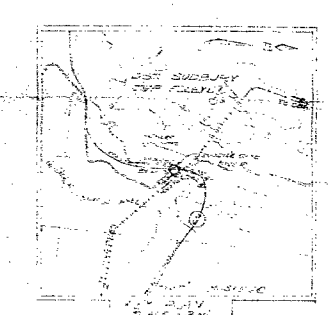

NO.	DATE	REVISION
1	10/1/80	1.0
2	10/1/80	1.1
3	10/1/80	1.2
4	10/1/80	1.3
5	10/1/80	1.4
6	10/1/80	1.5
7	10/1/80	1.6
8	10/1/80	1.7
9	10/1/80	1.8
10	10/1/80	1.9

DEPARTMENT OF HIGHWAYS-ONTARIO BRIDGE OFFICE-TORONTO			
IVANHOE RIVER BRIDGE AT FOLEYET			
THE KING'S HIGHWAY NO. 104		DIST. NO. 104	
TWP. FOLEYET		LOT 2 CON. 104	
PLAN & ELEVATION			
APPROVED			
BRIDGE ENGINEER		DESIGN ENGINEER	
DESIGN	CHECK	DESIGN	CHECK
DRAWING	CHECK	DRAWING	CHECK
DATE	10/1/80	DATE	10/1/80