

ACAD FILE M1103001.DWG

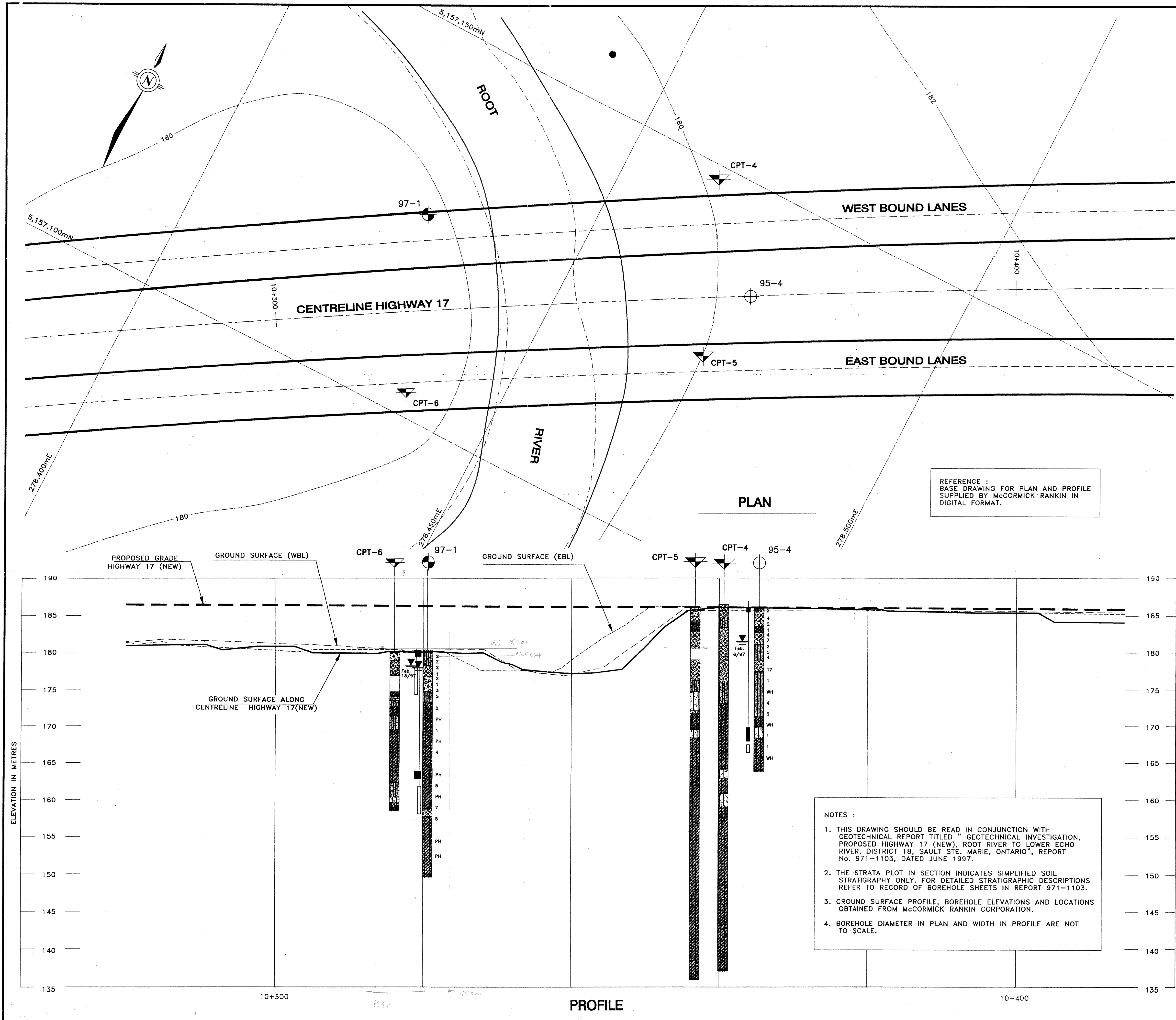

HIGHWAY 17 (New)  
SAULT STE. MARIE to BAR RIVER ROAD

**LEGEND**

97-1 BOREHOLE LOCATION - CURRENT INVESTIGATION

95-4 BOREHOLE LOCATION - PREVIOUS INVESTIGATION BY GOLDER ASSOC. LTD. (REPORT 941-1364)

CPT-5 CONE PENETRATION TEST - CURRENT INVESTIGATION

BENTONITE SEAL

WATER LEVEL

PIEZOMETER

'N' VALUE, blows/0.3m

STRATA PLOT (SEE DESCRIPTIONS BELOW)

**STATIGRAPHY DESCRIPTIONS**

- TOPSOIL
- SANDY SILT with fine to medium sand layers, trace organics Very loose, brown
- SAND, fine to coarse, trace to some silt, trace gravel, trace organics, Very loose to compact, brown and grey
- SAND and GRAVEL, grading to sand, with some gravel Very loose, grey
- SILT, SANDY SILT and CLAYEY SILT, interlayered, trace organics Loose to very loose/soft, grey
- SILTY CLAY to CLAY and CLAYEY SILT to SILT, trace sand, irregularly layered, Firm to stiff, greyish brown to brown
- SILTY SAND, Very loose

0 5.0 10.0 15.0 20.0 25.0m

SCALE 1:250

NO.	DATE	REVISION	BY	CHK	ENG	APP

**Golder Associates Ltd.**  
MISSISSAUGA, ONTARIO, CANADA

**MCCORMICK RANKIN CORPORATION**  
MISSISSAUGA, ONTARIO

**HIGHWAY 17**

**PLAN AND PROFILE  
ROOT RIVER BRIDGE**

DRAWN: MHW	CHKD: AMP	1	REV.
DATE: MARCH 16, 1997	PROJECT NO.: 971-1103		

DRAWING NUMBER