

ACAD FILE M110304A.DWG

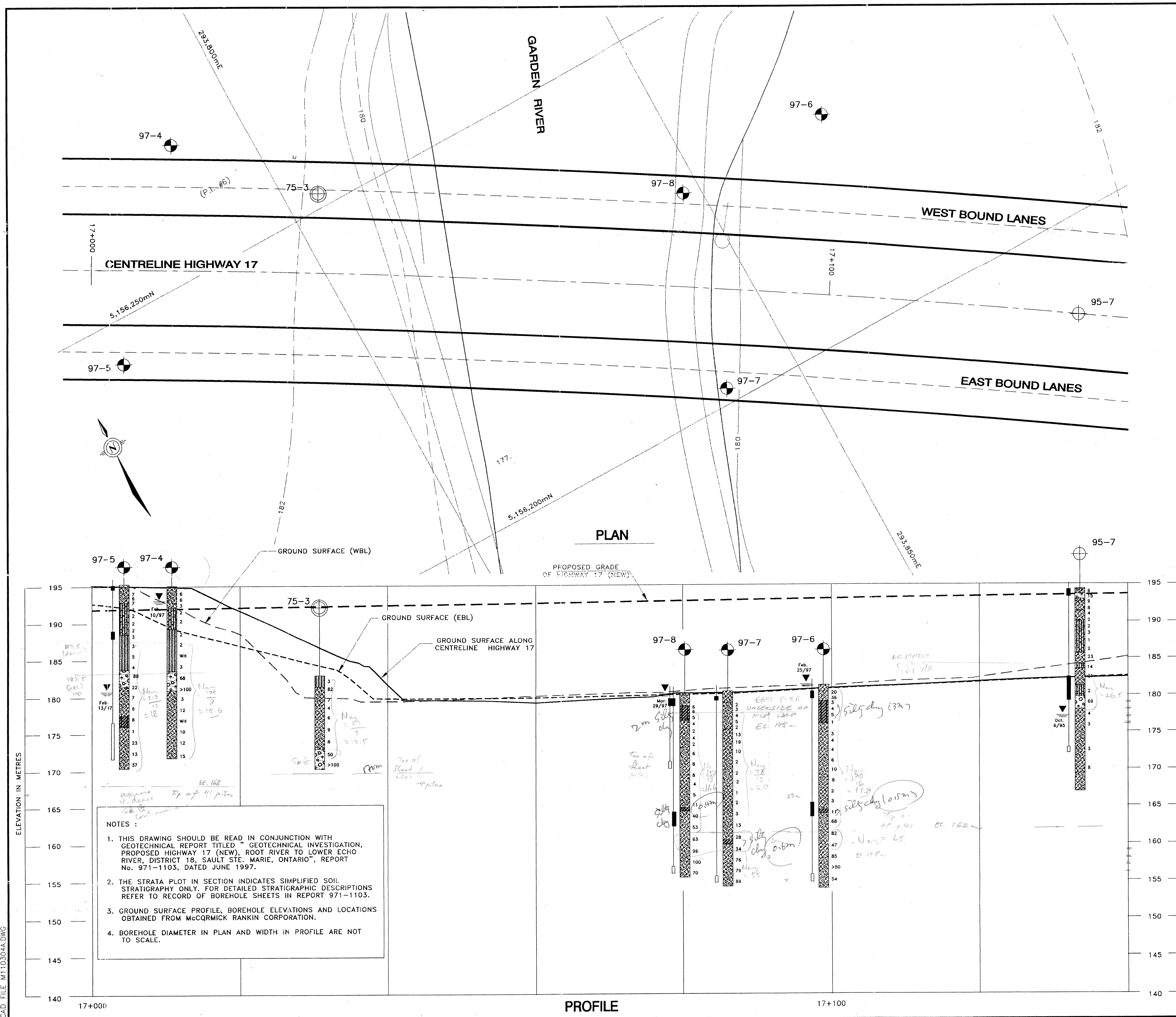

HIGHWAY 17 (New)  
SAULT STE. MARIE TO BAR RIVER ROAD

**LEGEND**

97-1 BOREHOLE LOCATION - CURRENT INVESTIGATION

97-4 BOREHOLE LOCATION - PREVIOUS INVESTIGATION BY GOLDER ASSOC. LTD. (REPORT 941-1364)

75-3 BOREHOLE LOCATION - PREVIOUS INVESTIGATION BY MTO (1975)

CPT-5 CONE PENETRATION TEST - CURRENT INVESTIGATION

BENTONITE SEAL

WATER LEVEL

PIEZOMETER

'N' VALUE, blows/0.3m

STRATA PLOT (SEE DESCRIPTIONS BELOW)

**STATIGRAPHY DESCRIPTIONS**

TOPSOIL

SANDY SILT and SILTY SAND, trace clay, some organics interlayered, Very loose, grey

SAND, fine to coarse, trace gravel, silt and silty clay interlayered, Very loose to very dense, brown to grey

SAND and GRAVEL, trace silt, cobbles and boulders Compact to very dense, brown and grey

SILT, SANDY SILT and SAND, trace clay, trace organics, interlayered, Very loose to loose, grey

SILTY CLAY, some sand, silt and sand partings/seams and fine sand, interlayered, Soft to firm/very loose to loose

REFERENCE :  
BASE DRAWING FOR PLAN AND PROFILE  
SUPPLIED BY MCCORMICK RANKIN IN  
DIGITAL FORMAT.

0 5.0 10.0 15.0 20.0 25.0m

SCALE 1:250

NO.	DATE	REVISION	BY	CHK	ENG	APP

**Golder Associates Ltd.**  
MISSISSAUGA, ONTARIO, CANADA

**MCCORMICK RANKIN CORPORATION**  
MISSISSAUGA, ONTARIO

**HIGHWAY 17**

**PLAN AND PROFILE**  
**GARDEN RIVER BRIDGE**

DRAWN: MHW	CHKD: AMP	4	
DATE: MARCH 16, 1997			
PROJECT NO.: 971-1103			
DRAWING NUMBER		REV.	