

# 66-F-27

W.P. # 299-60

Hwy. # 401 E

DILLON

SIDE RD.

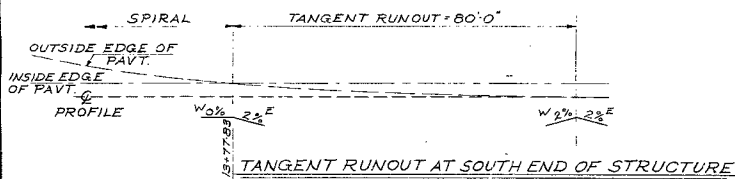
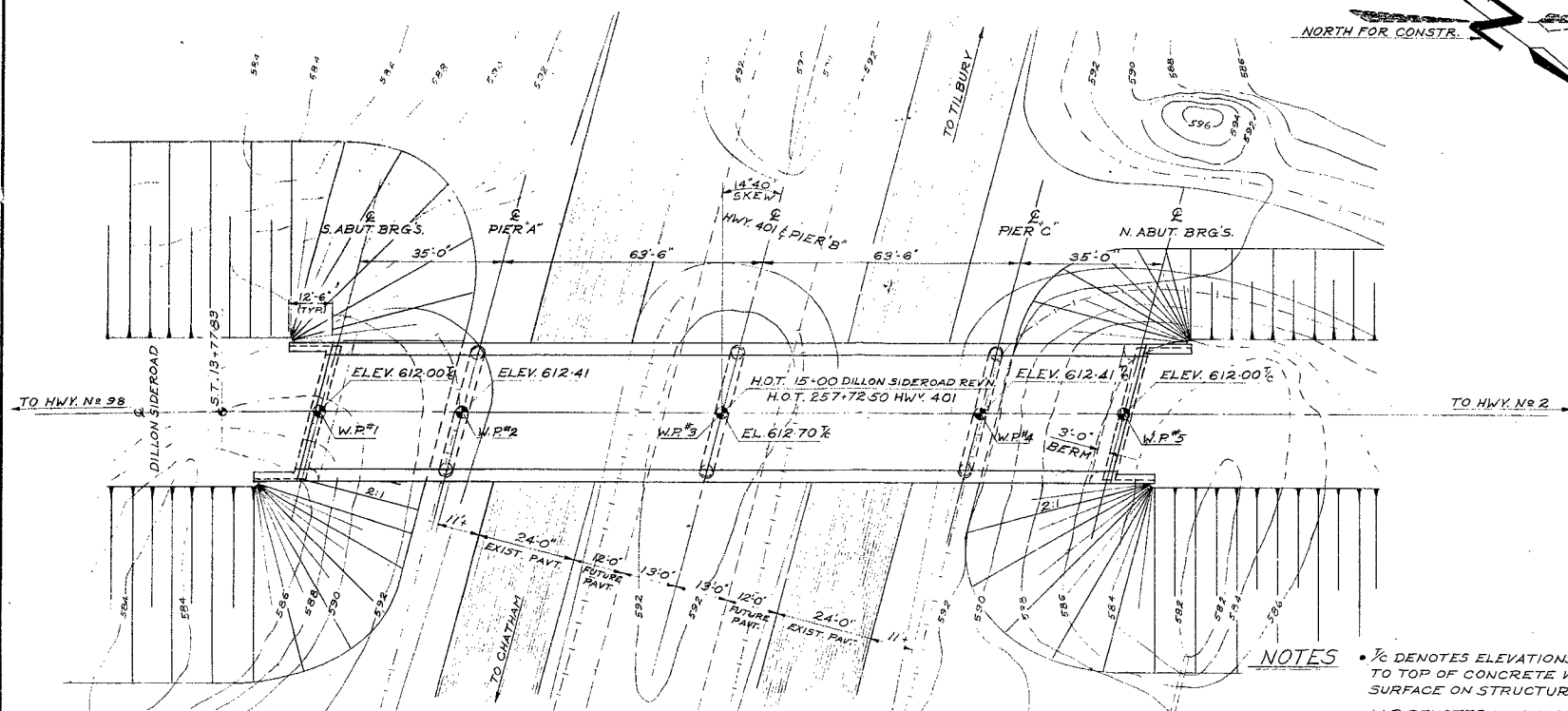

14°40' SKEW	
SIN.	0.25320
COS.	0.96742
TAN.	0.26172
SEC.	1.03368

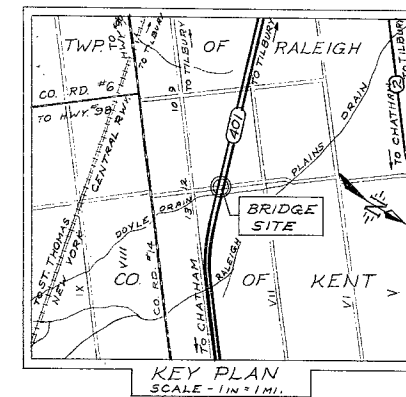
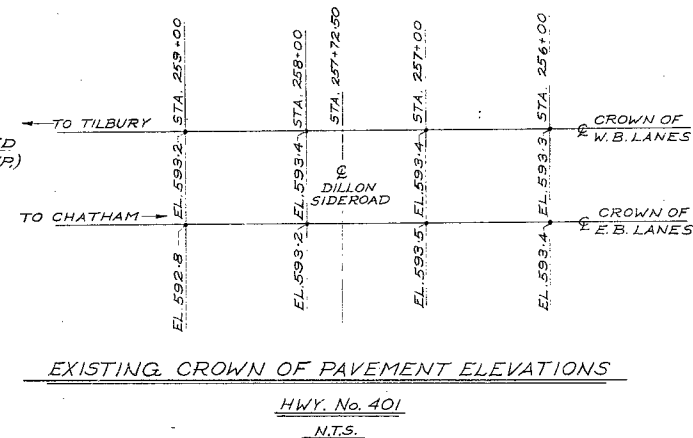
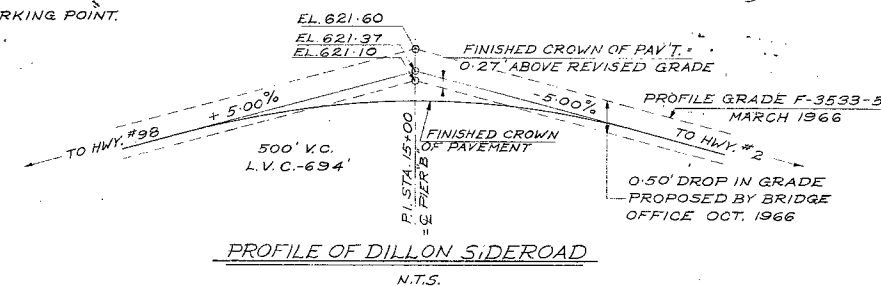
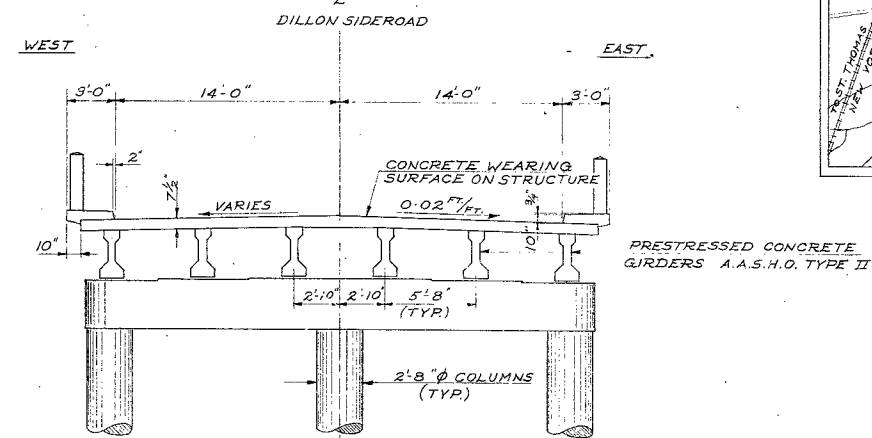
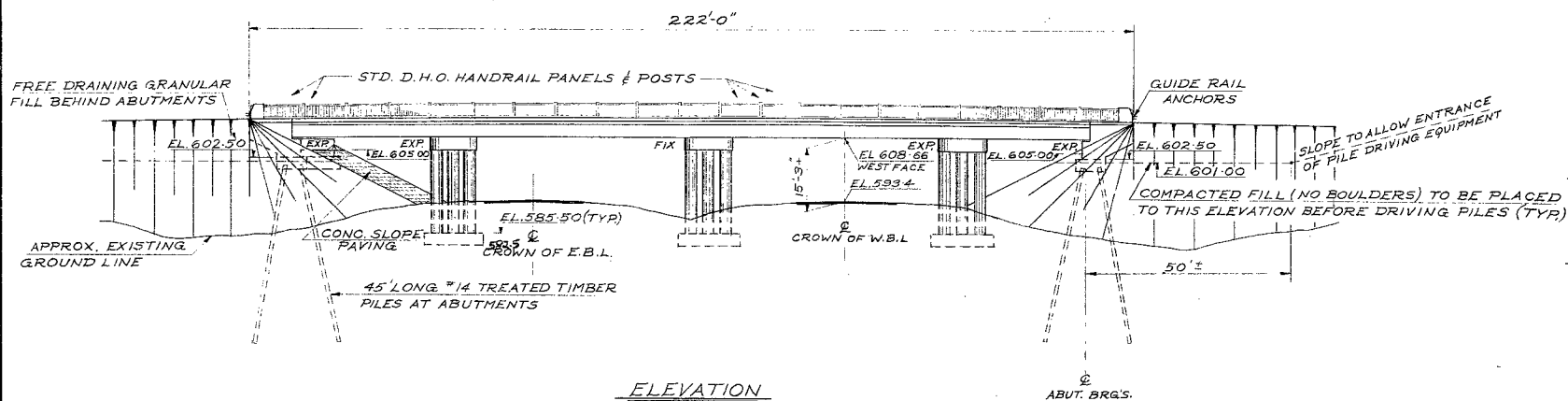

B.M. ELEV. 593.87  
GEODETIC DATUM CUT 'X' ON S.W. CURB  
593 LT. OF STA. 255+67

REVISIONS	DATE	BY	DESCRIPTION

DEPARTMENT OF HIGHWAYS ONTARIO  
BRIDGE DIVISION

**DILLON SIDEROAD UNDERPASS**  
9.0 MILES EAST OF EAST JCT. HWY. 2 TILBURY

KING'S HIGHWAY No. 401 DIST. No. 1  
CO. OF KENT  
TWP. OF RALEIGH LOT 12 CON. 7

PRELIMINARY PLAN

APPROVED  
BRIDGE ENGINEER  
DESIGN K.G.B. CHECK  
DRAWING R.A.J. CHECK  
DATE OCT. 66 LOADING H520-44

SITE No. 13-292 W.P. No. 299-60  
CONTRACT No. 7  
DRAWING No. D-6040-P1



66-F-27

MEMORANDUM

To:

Mr. A. Stermac,  
Principal Foundation Engineer,  
Room 107,  
Lab. Building.

From:

Bridge Division,  
Downsview, Ontario

Date:

February 18, 1966

Our File Ref.

In Reply To

SUBJECT:

W.P. 299-60  
Site 13-292  
Dillon Sideroad Underpass,  
Highway 401, District 1

66-6-27

We are sending to you herewith two prints of Bridge Site Plan E-4368-1 on which we have marked in red the proposed location of the above structure.

The bridge site is readily accessible. It is 9 miles east of east junction of Highway No. 2.

Please make the necessary arrangements for foundation soils investigation. We will be pleased to have your report in due course.

*N. Zoltay*

WZ/pr  
Encl.

N. Zoltay,  
for G. Scott,  
Regional Bridge Location Engineer.

cc. S. McCombie  
G. Scott  
A. P. Watt  
R. Forrest  
A. Crowley

DEFECTS IN NEGATIVE DUE TO  
CONDITION OF ORIGINAL DOCUMENT

RECEIVED FEB 22 1966