

#64-F-212C
W.P. #139-60
HWY #18
TURKEY CREEK

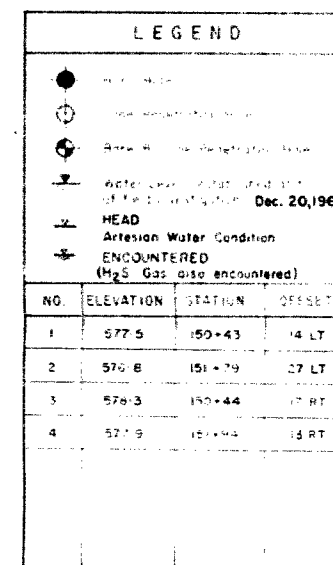

- NOTE -

The boundaries between soil strata have been established only at Bore Hole locations. Between Bore Holes the boundaries are assumed from geological evidence and may be subject to considerable error.

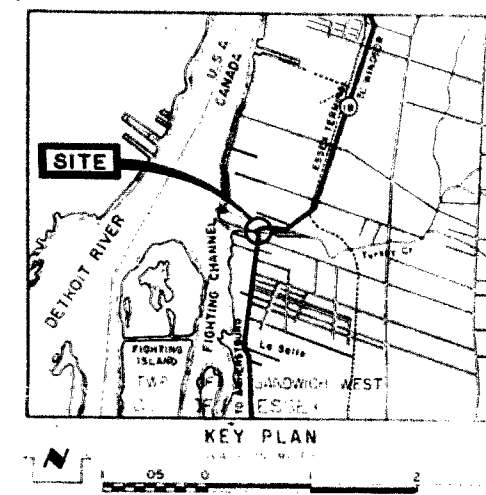
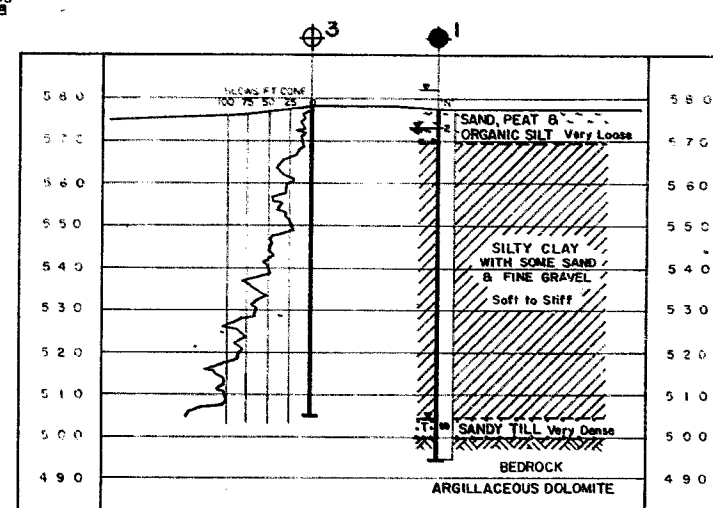

B-B

DRAWING NO.
T756

SUBMD DBO.	CHECKED R.H.	WP NO - 139 - 60	BY DR. LARA M. M.
DRAWN A.E.L.	CHECKED DBO.	JOB NO	
DATE JANUARY 13, 1964	SITE NO	BY THE DRAWING NO.	
APPROVED, <i>Red Christie</i>	CONT NO		

COUNTY OF ESSEX
TOWNSHIP OF SANDWICH WEST
CON 1

LOT 35 LOT 36

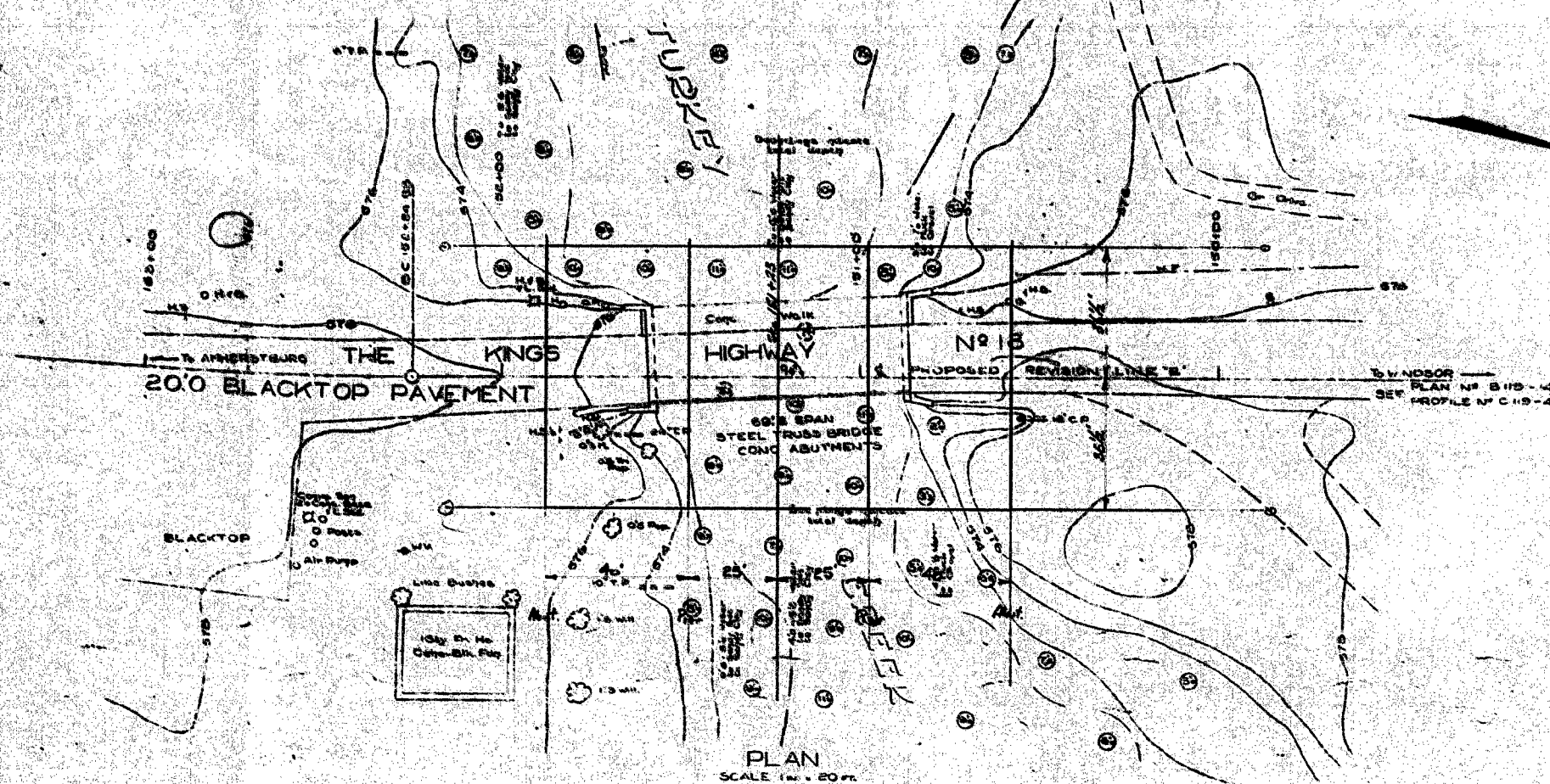

SKETCH SHOWING PROPOSED LOCATION OF STRUCTURE
AS SUBMITTED FOR FOUNDATION SOILS
INVESTIGATION. NOVEMBER 8TH 1963

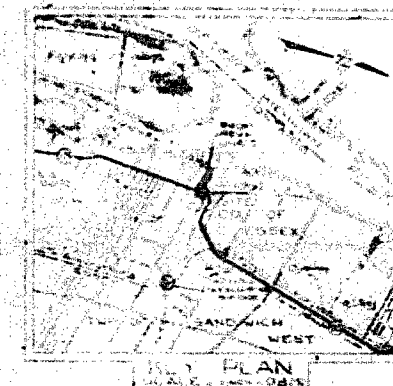

G.B.M. NO. MNMOXIX ELEV. 576.3.81

Steel truss bridge over Turkey Creek, on a proposed highway alignment, crossing the highway at right angles. The bridge is to be constructed of steel and concrete. The bridge is to be constructed of steel and concrete. The bridge is to be constructed of steel and concrete.

DATE REVISIONS / ADDITIONS BY

DEPARTMENT OF HIGHWAYS - ONTARIO
SOUTH-WESTERN REGION
DISTRICT NO. 1
PROPOSED CROSSING
AT
TURKEY CREEK
THE KING'S HWY NO. 18
TOWNSHIP OF SANDWICH WEST, COUNTY OF ESSEX

BRIDGE SITE

SURVEY BY	BY	APPROVED
CHIEF OF PARTY	M. J. LEAN	
SUPERVISOR	W. SMITH	
DRAWN BY	P. WOLFE	
DRAFTSMAN	J. CAMPBELL	
SUPERVISOR	BY	
CHIEF OF PARTY		
SUPERVISOR		

PLAN E-4300-1
WP 139-60

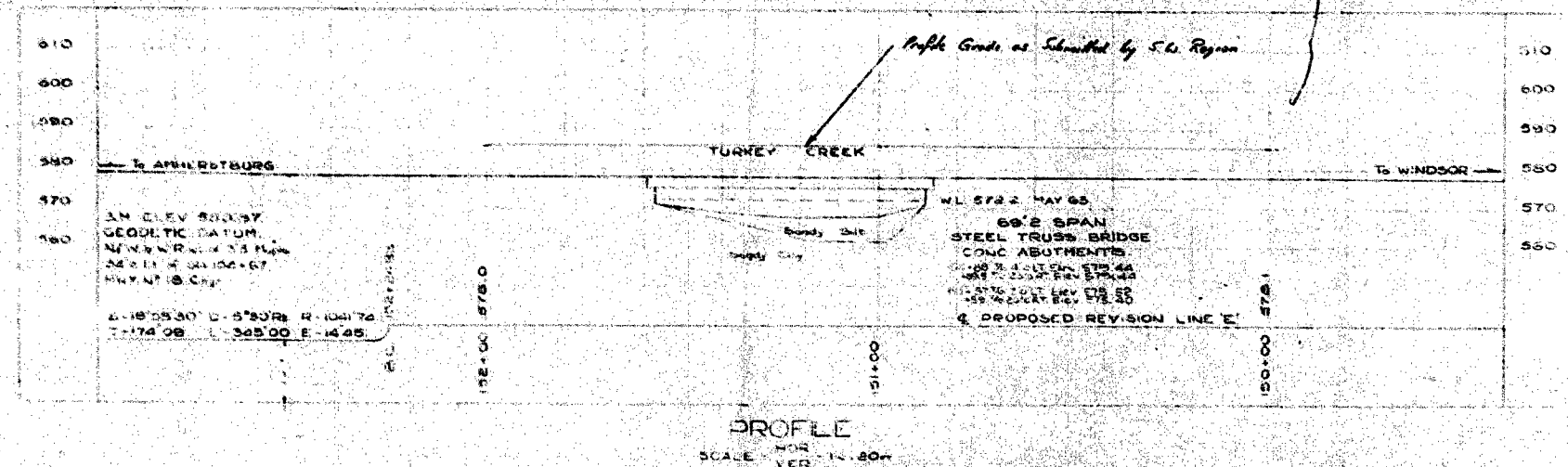

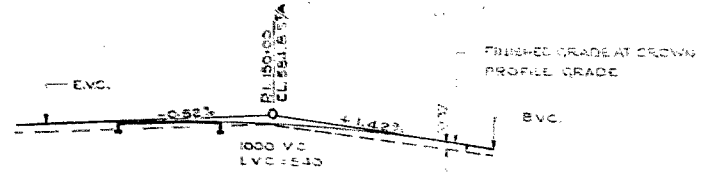
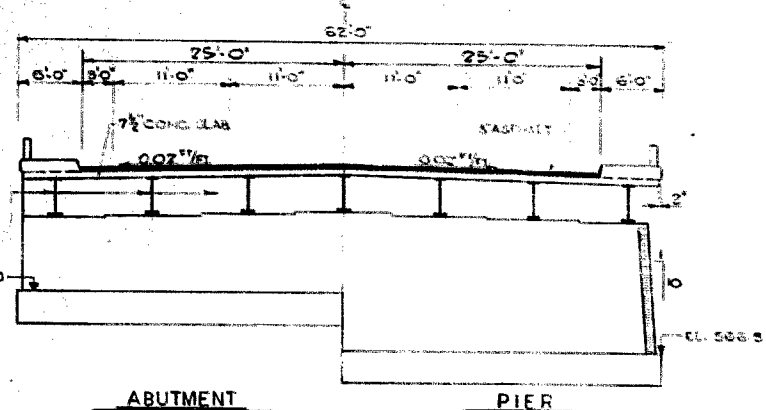
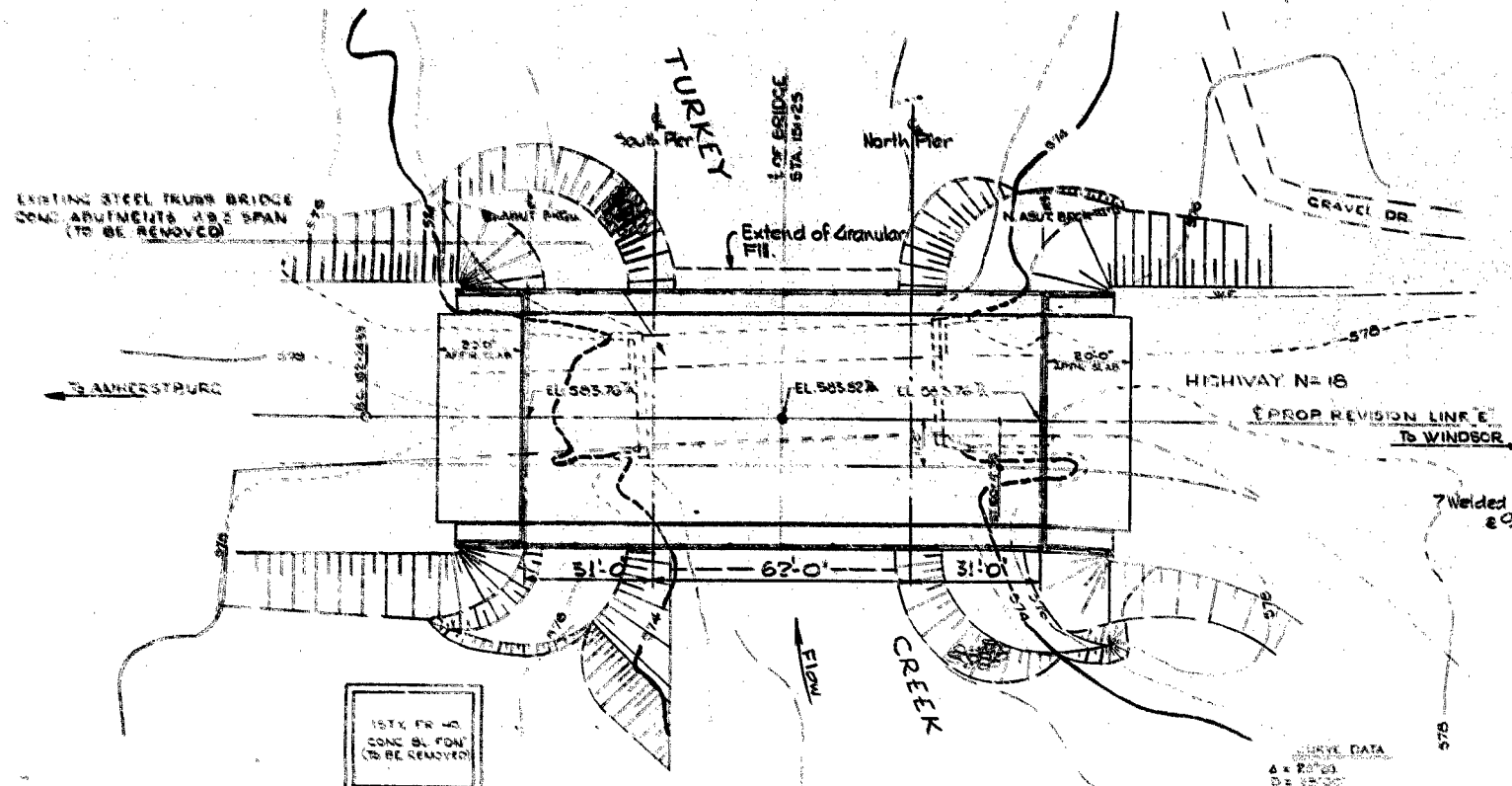
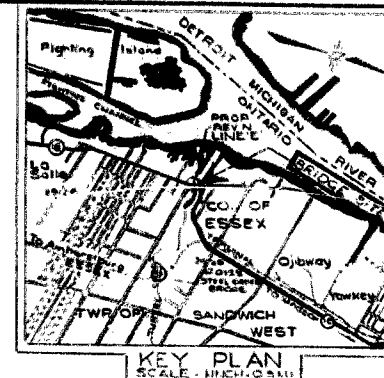

SPRUE DATA
 Δ = 25.00
 D = 35.00
 R = 100.00
 T = 30.00
 L = 20.00
 TS = 20.00

SPIRAL CURVE DATA
 Ls = 150'
 Δs = 25.00
 LT = 101.35
 ST = 51.21

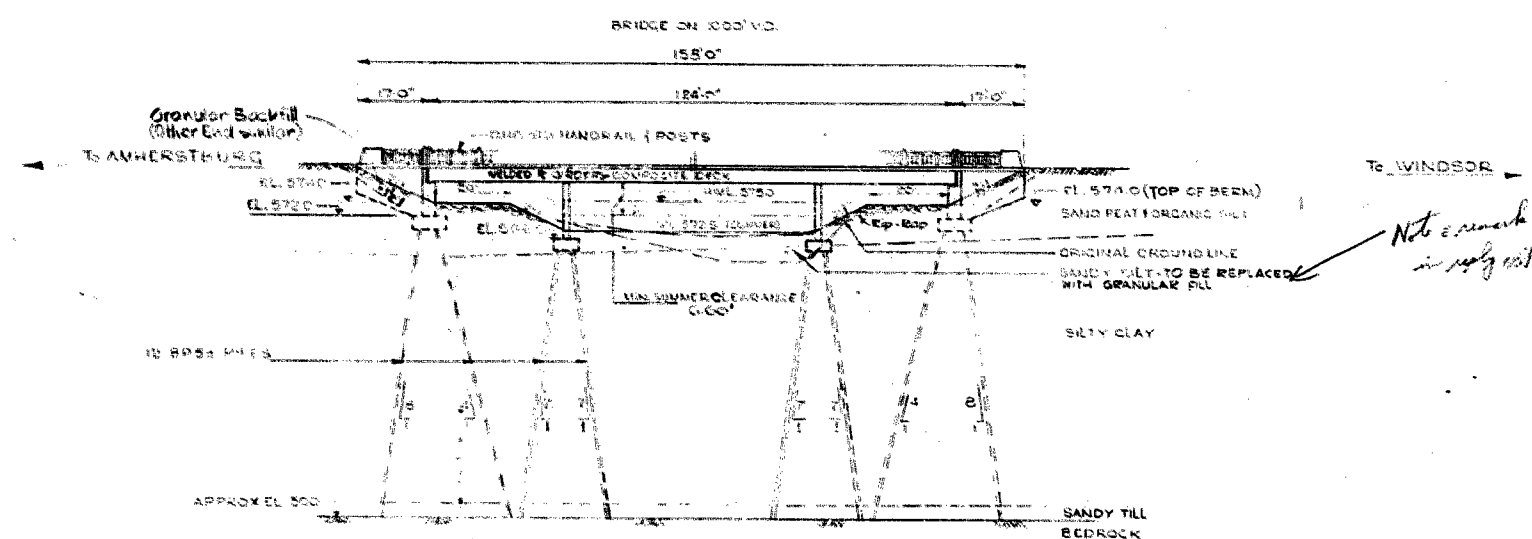

Note: remark in reply not

REVISIONS	DATE	BY	DESCRIPTION

Reference Plans
 Site Plan E4300-1
 Location Plan 128119
 Profile C1048-2
 Soil Report BA1575-A



DEPARTMENT OF HIGHWAYS ONTARIO BRIDGE DIVISION			
TURKEY CREEK BRIDGE AT LA SALLE			
KING'S HIGHWAY No. 18		DIST. No. 1	
CO. ESSEX		TWP. SANDWICH WEST LOT 35436 CON. 1	
PRELIMINARY PLAN			
APPROVED		SITE No. 2-53 W.P. No. 139-60	
DESIGN	FG.	CHECK	CONTRACT No.
DRAWING	R.J.H.	CHECK	DRAWING No.
DATE	AUG 64	LOADING	10/20/66