

#60-f-282-c

W.P. #22-59-02

DINGMAN RD.

CREEK CROSSING

NEAR LONDON

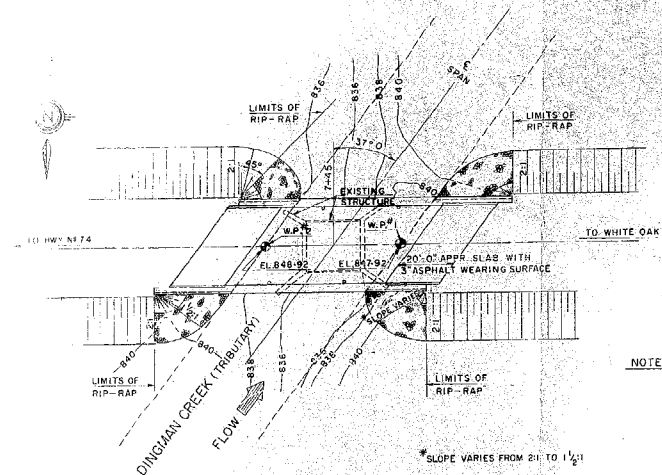

NOTE:
 - $\frac{1}{2}$ DENOTES ELEVATIONS ARE TO TOP OF CONCRETE WEARING SURFACE
 - W.P. DENOTES WORKING POINT

*SLOPE VARIES FROM 2H:1 TO 1 1/2:1

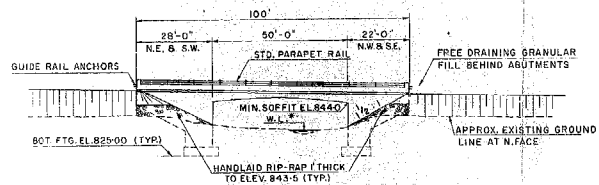

*WATER LEVELS

835-05 JUNE 59
 842-50 JAN. 60
 ESTIMATED 25 YR FLOOD + 842'00

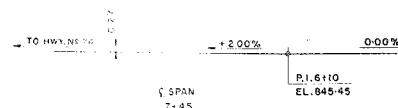
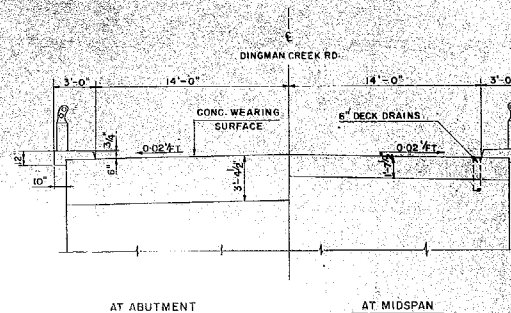

R.D.O. NOTE:

- GRADE LOWERED FROM THAT SHOWN ON PROFILE C-94-22
- LOCATION OF R.L. CHANGED

FUNCTIONS OF 37°0'0"

SIN 0.601815
 COS 0.798636
 TAN 0.753554
 SEC 1.252136

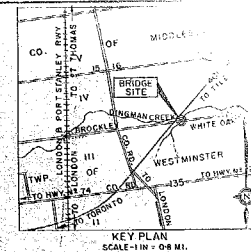

"GLANWORTH"

G.B.M. ELEV. 859.107 N° 1686

PLATE GIRDER BRIDGE ON LONDON AND FORT STANLEY R.WY., 3 1/4 MILES NORTH OF STATION AND 320 FT. SOUTH OF CROSSING OF ROAD BETWEEN CONS. III AND IV, TWP. OF WESTMINSTER, AT STOP 5, NORTH STONE ABUTMENT, TABLE IN TREAD OF SECOND ALTAIR STEP BELOW CAP STONE, AT EAST SIDE OF TRACK, 8 INCHES FROM SOUTH EDGE AND 8 INCHES FROM EAST EDGE.

DATE	BY	DESCRIPTION

DEPARTMENT OF HIGHWAYS ONTARIO	
BRIDGE DIVISION	
DINGMAN CREEK TRIBUTARY BRIDGE	
WING'S HIGHWAY No. TWP. RD.	DIST. No. 2
CO. OF MIDDLESEX	WESTMINSTER TWP. BRIDGE
TWP. OF WESTMINSTER	LOT 18 CON. III & IV
PRELIMINARY PLAN	
APPROVED	SHEET No. 19-361 W.P. No. 22-59-2
DESIGN J.K.C. CHECK	CONTRACT No.
DRAWING R.A.J. CHECK	DRAWING No.
DATE JUNE 67	LOADING HS20-44

#60-F-282-C

W.P. #22-59-02

DINGMAN RD.

CREEK CROSSING

NEAR LONDON

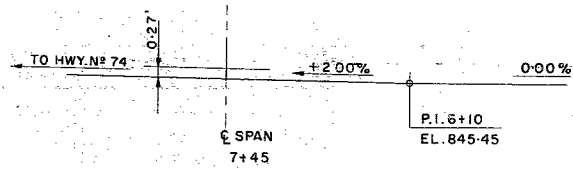
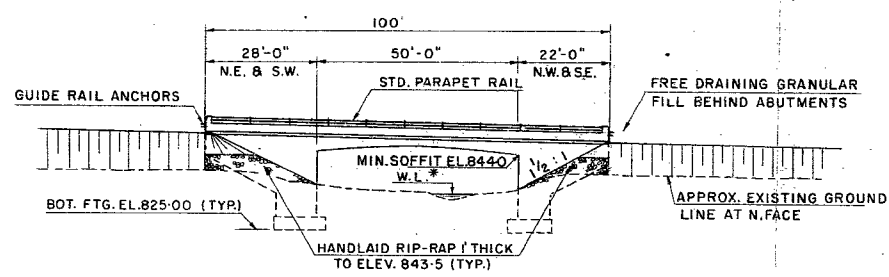
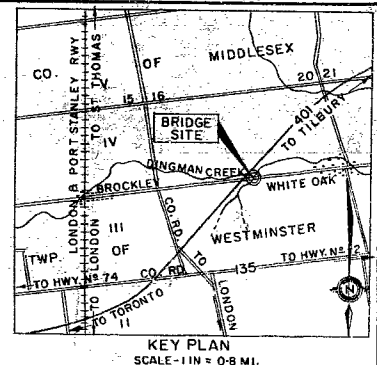
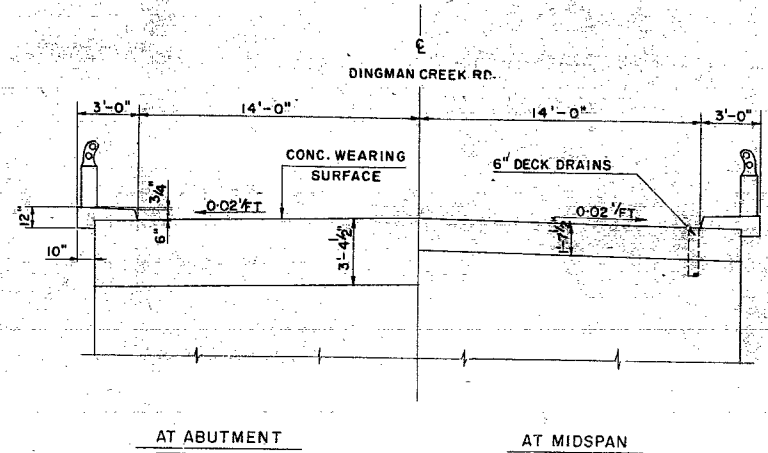
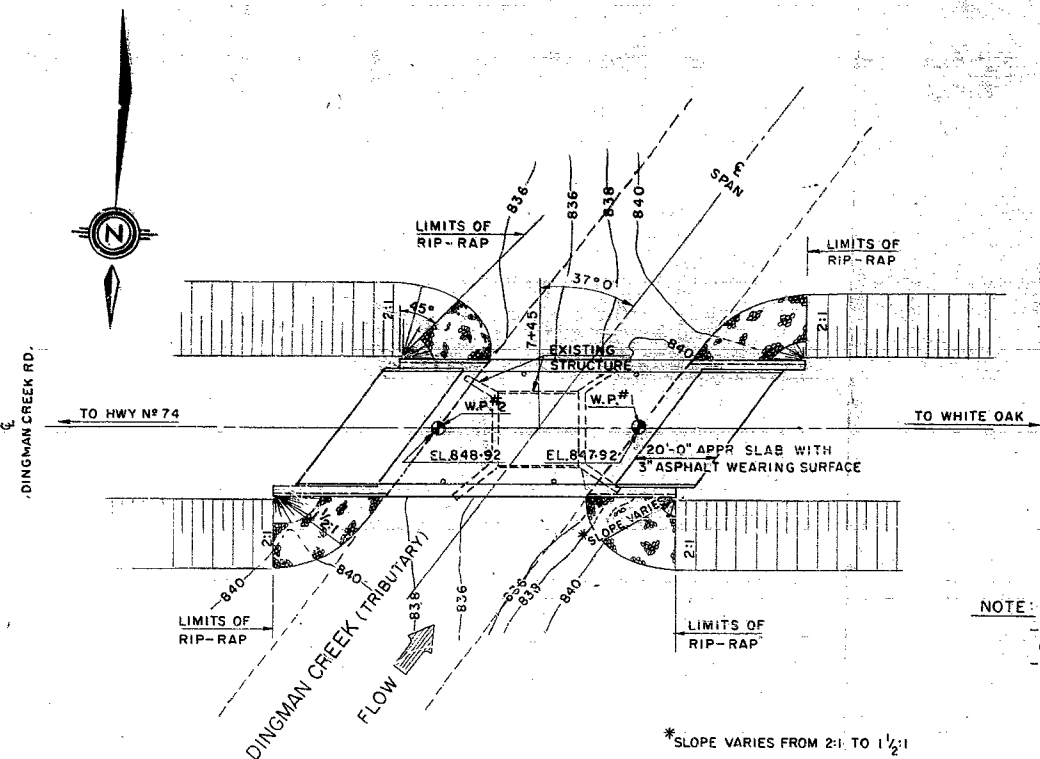

FUNCTIONS OF 37°0'0"

SIN. 0.601815
COS. 0.798636
TAN. 0.753554
SEC. 1.252136

* WATER LEVELS
835-05 JUNE 59
842-50 JAN. 60
ESTIMATED 25 YR FLOOD = 842-00

"GLANWORTH"
G.B.M. ELEV. 859-107 N° 16B6

PLATE GIRDER BRIDGE ON LONDON AND FORT STANLEY R.W., 3 1/4 MILES NORTH OF STATION AND 320 FT. SOUTH OF CROSSING OF ROAD BETWEEN CONS. III AND IV, TWP. OF WESTMINSTER, AT STOP 5, NORTH STONE ABUTMENT, TABLE IN TREAD OF SECOND ALTAIR STEP BELOW CAP STONE, AT EAST SIDE OF TRACK, 8 INCHES FROM SOUTH EDGE AND 8 INCHES FROM EAST EDGE.

R.D.O. NOTE:
- GRADE LOWERED FROM THAT SHOWN ON PROFILE C-94-22
- LOCATION OF RI. CHANGED

REVISIONS	DATE	BY	DESCRIPTION
1	JUN 67	J.L.K.	THIS DRAWING SUPERSEDES PREVIOUS DESIGN DRAWINGS D-4502

DEPARTMENT OF HIGHWAYS ONTARIO BRIDGE DIVISION			
DINGMAN CREEK TRIBUTARY BRIDGE			
KING'S HIGHWAY No. TWP. RD.		DIST. No. 2	
CO. OF MIDDLESEX		WESTMINSTER TWP. BRIDGE	
TWP. OF WESTMINSTER		LOT 18 CON. III & IV	
PRELIMINARY PLAN			
APPROVED		SITE No. 19-361 W.P. No. 22-59-2	
DESIGN J.L.K. CHECK		CONTRACT Nos.	
DRAWING R.A.J. CHECK		DRAWING No. D-6267-PI	
DATE JUNE 67		LOADING HS20-44	