

COPY- FOUNDATIONS
DEPARTMENT OF HIGHWAYS ONTARIO
MEMORANDUM

OFFICE

(RM-113)
Sept. 28-9.

TO: Mr. F. E. Cavell,
Superintendent,
Special Services Section.

FROM: Mr. A. G. Stermac,
Principal Foundation Engr.
Foundation Section,
Materials & Research Division.

DATE: September 26, 1962.

OUR FILE REF.

IN REPLY TO

SUBJECT:

D.H.O. FOUNDATION INVESTIGATION -
Proposed Patrol Yard at Cobden,
Lot 6, Con. I, Twp. of Westmeath,
Hwy. #7, District #9.
W.J. 62-F-113 -- W.P. (N11).

Attached, we are forwarding to you, the report
for the above mentioned site.

We believe the information contained in the
report will prove to be adequate for your further work.
However, should there be any additional information that
you would require, please feel free to call on our Office.

AGS/MdeF
Attach.

A. G. Stermac
A. G. Stermac,
PRINCIPAL FOUNDATION ENGINEER

cc: Messrs. F. E. Cavell (4)✓
H. A. Tregaskes
H. D. McMillan
L. E. Walker
J. E. Gruspier
J. Roy
T. J. Kovich
E. R. Saint
F. Norman
Foundations Office✓
Gen. Files.

FOUNDATION INVESTIGATION

For

Proposed Patrol Yard at Cobden,
Lot 6, Con. I, Twp. of Westmeath,
Hwy. #7, District #9.
W.J. 62-F-113 -- W.P. (Nil).

A foundation investigation at the site of the proposed new D.H.O. Patrol Yard at Cobden was requested by Mr. F. E. Cavell in a memo dated August 15th. A field investigation was subsequently carried out by the Kingston Regional Soils Section to determine the subsoil conditions at the site. Following, is a summary of the results of this investigation, together with recommendations pertaining to the design of the proposed structure foundations and the roadways and gravelled areas.

A total of 6 borings was carried out utilizing a power auger. The maximum depth penetrated was 12.0'. The locations and elevations of all borings are shown on Drawing #62-F-113A, which will follow later. Subsoil at the site was found to consist of from 3 to 6 feet of stiff clayey silt followed by a deposit of firm to stiff silty clay extending for the remaining depths of the boreholes.

It is proposed to erect a new 4 Bay Garage at the site, together with a salt shed and various roadways and gravelled areas. The foundations for the buildings should be placed at a sufficient depth for frost protection, which would be about 6' below finished ground level. A design load of 0.75 tons/sq.ft. may be used in this case. For roadways and gravelled

areas, a minimum of 21" of suitable granular fill is recommended. The top 6" of this latter should consist of G.B.C. Class 'A' material. Topsoil stripping should be carried out as per D.H.O. Standards. The proposed sand pile may be built to a height of twenty-five feet without danger of base failure.

The field investigation was carried out by the Kingston Regional Soils Section on September 5th, 1962. Equipment used was owned and operated by the Department of Highways under the supervision of Mr. W. Latimer. This report was prepared by Mr. K. G. Selby of the Foundation Section.

September 1962.

Mr. F. E. Cavell,
Superintendent,
Special Services Section.

Mr. A. G. Stermac,
Principal Foundation Engr.
Foundation Section,
Materials & Research Division.
September 26, 1962.

D.H.O. FOUNDATION INVESTIGATION -
Proposed Patrol Yard at Cobden,
Lot 6, Con. I, Twp. of Westmeath,
Hwy. #7, District #9.
W.J. 62-F-113 -- W.P. (Nil).

Attached, we are forwarding to you, the report
for the above mentioned site.

We believe the information contained in the
report will prove to be adequate for your further work.
However, should there be any additional information that
you would require, please feel free to call on our Office.

AGS/MdeF
Attach.

A. G. Stermac
A. G. Stermac,
PRINCIPAL FOUNDATION ENGINEER

cc: Messrs. F. E. Cavell (4)
H. A. Tregaskes
H. D. McMillan
L. E. Walker
J. E. Gruspier
J. Roy
T. J. Kovich
E. R. Saint
P. Norman
Foundations Office
Gen. Files.

FOUNDATION INVESTIGATION

For

Proposed Patrol Yard at Cobden,
Lot 6, Con. I, Twp. of Westmeath,
Hwy. #7, District #9.
W.J. 62-F-113 -- W.P. (Nil).

A foundation investigation at the site of the proposed new D.H.C. Patrol Yard at Cobden was requested by Mr. F. E. Cavell in a memo dated August 15th. A field investigation was subsequently carried out by the Kingston Regional Soils Section to determine the subsoil conditions at the site. Following, is a summary of the results of this investigation, together with recommendations pertaining to the design of the proposed structure foundations and the roadways and gravelled areas.

A total of 6 borings was carried out utilizing a power auger. The maximum depth penetrated was 12.0'. The locations and elevations of all borings are shown on Drawing #62-F-113A, which will follow later. Subsoil at the site was found to consist of from 3 to 6 feet of stiff clayey silt followed by a deposit of firm to stiff silty clay extending for the remaining depths of the boreholes.

It is proposed to erect a new 4 Bay Garage at the site, together with a salt shed and various roadways and gravelled areas. The foundations for the buildings should be placed at a sufficient depth for frost protection, which would be about 6' below finished ground level. A design load of 0.75 tons/sq.ft. may be used in this case. For roadways and gravelled

areas, a minimum of 21" of suitable granular fill is recommended. The top 6" of this latter should consist of G.B.C. Class 'A' material. Topsoil stripping should be carried out as per D.H.O. Standards. The proposed sand pile may be built to a height of twenty-five feet without danger of base failure.

The field investigation was carried out by the Kingston Regional Soils Section on September 5th, 1962. Equipment used was owned and operated by the Department of Highways under the supervision of Mr. W. Latimer. This report was prepared by Mr. K. G. Selby of the Foundation Section.

September 1962.

#62-F-113

PROPOSED

PATROL YD.

AT COBDEN

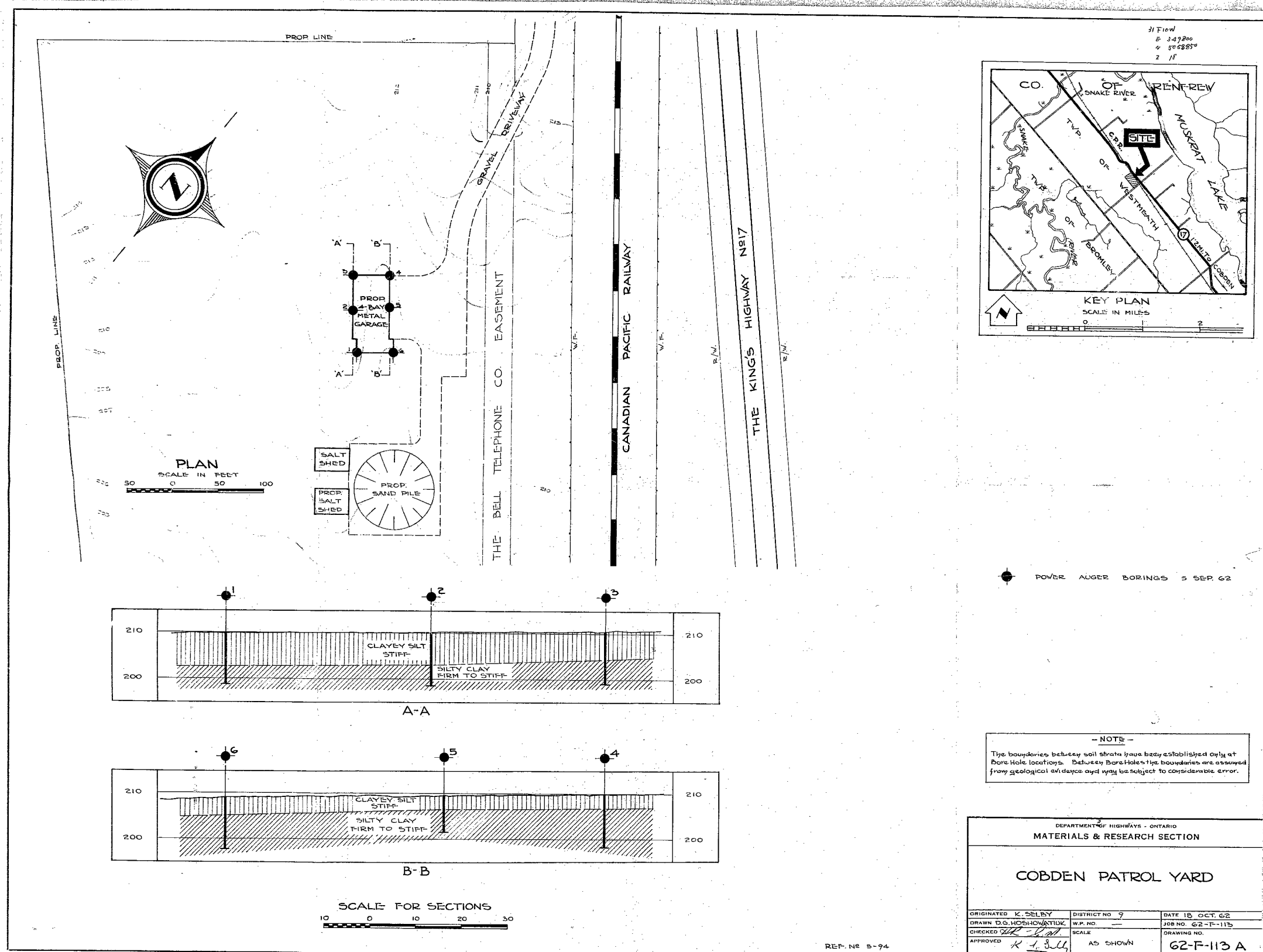

REF. NO. B-94