

#55-F-42

HWY #401 &

SIDNEY ST.

JUNCTION

55 F-42

Mr. A. Toye,
Bridge Engineer,
F.C. Brownridge

June 3, 1955
Re: Bridge No. 3 at
Trenton

We enclose two copies of the report of our investigation at the above proposed bridge site.

A plan of the bore holes taken is attached which shows the levels of the bedrock. The investigation was carried out without the use of boring equipment and consequently the pattern of the points of inspection is unusual. However, the general flatness of the rock bed, as indicated on the plan, would justify this approach; and the validity of the conclusions.

Encl.

AT:JH

(A. Thorley)

copies to: Mr. J. Walter,
Mr. H. Duff,
File ✓

Proposed Structure

at the

Junction

of

Highway 401

and

Sidney Street

at

Trenton.

Copies to:

Mr. A. Toye
Bridge Engineer (2)

Mr. J. Walter
Construction Engineer (1)

Mr. H. Duff
Division Engineer (1)

File (2)

Bridge Plan	E 2797-1
Profile	F 3007-4
Plan	F 3653-3

Introduction

Previous preliminary borings in the general location of this proposed bridge site indicated the presence of rock close to the surface.

Subsequently a detailed survey of the proposed site revealed an area of very level rock which from surface inspection appeared to be horizontally bedded which dipped slightly in a northwesterly direction.

A plan of the holes is attached showing the elevations of rock which were observed directly.

Soil Profile

The attached plan indicates the level of the existing ground which, except in the case of fill material placed during the adjacent construction on highway 401, is within a few inches of the level of bedrock.

Inspection of the upper rock level shows a weathered and shattered condition probably resulting from frost action.

The rock in this area is reported to be sedimentary limestone (Putman & Chapman).

Recommendations

The foundations should be brought to sound rock which appears to be approximately 5'6" below proposed G.B.C. grade. The weathered rock should be excavated after stripping the light overburden.

HWY 401

TWP. SIDNEY COUNTY. HASTINGS
LOCATION 2M. N. TRENTON. LOT A. CON. II

PROF. F3007-14 (401-5-13)

PLAN. F3663-3

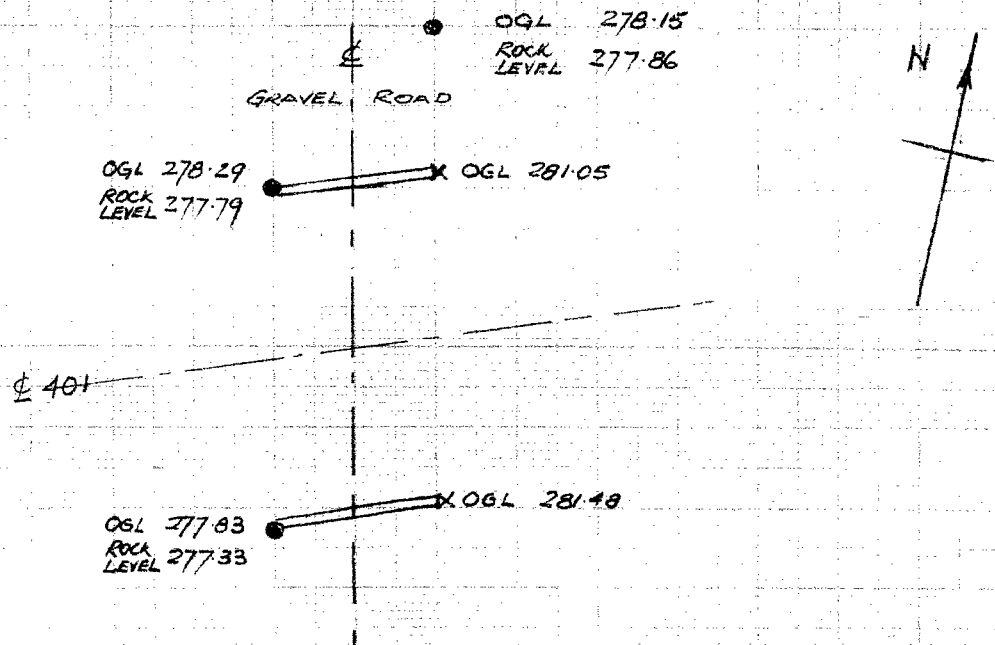
PLAN OF HOLES

OGL 279.88
ROCK LEVEL 278.38

- NOTE
- WESTERLY HOLES IN DITCH LINE
 - EASTERLY HOLES ROCK LEVEL SEEN IN DITCH LINE
 - AREA OF ABUTMENTS ON EASTERLY SECTION IS COVERED BY FILL PLACED IN CONSTRUCTION OF HWY 401

31ST MAY 1955 A. THORLEY

HWY 401 TWP. SIDNEY COUNTY, HASTINGS
LOCATION 2M N. TRENTON LOT A CONT

PROJ. F3007-11 (401-5-13)
PLAN F3653-3

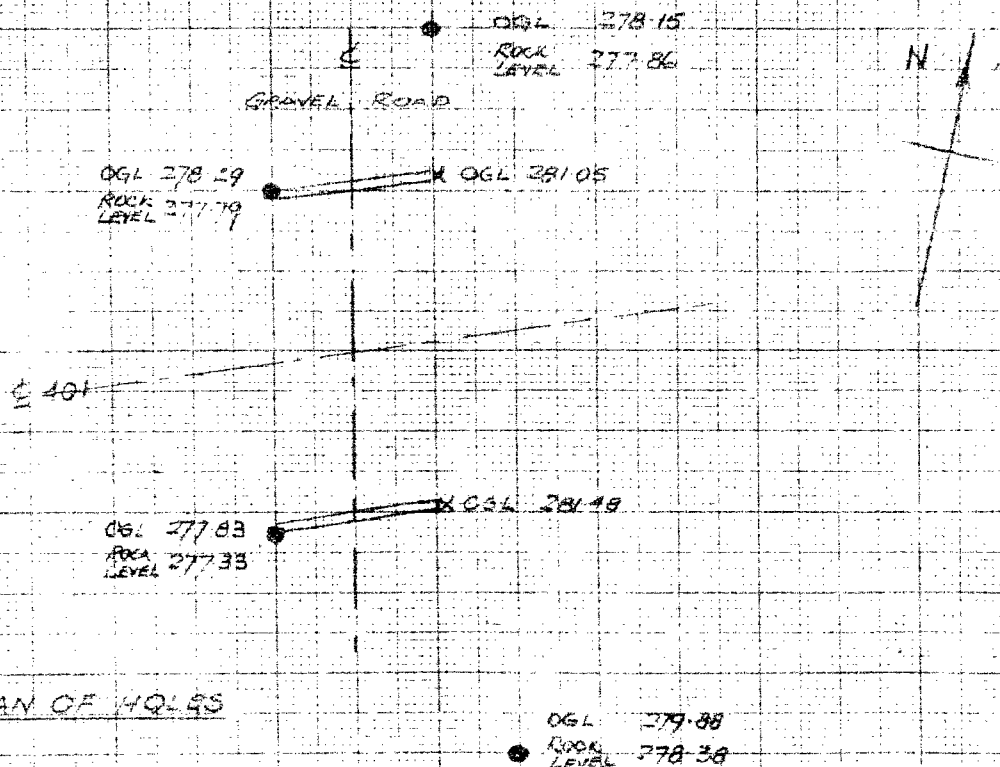

PLAN OF HOLES

- NOTE
- WESTERLY HOLES IN DITCH LINE
 - EASTERLY HOLES ROCK LEVEL SEEN IN DITCH LINE
 - AREA OF ABUTMENTS ON EASTERLY SECTION IS COVERED BY FILL PLACED IN CONSTRUCTION OF HWY. 401

30th MAY 1955 A. HURLEY