



**Submitted To AECOM Canada Ltd.  
189 Wyld Street Suite 103, North Bay, Ontario P1B 1Z2  
On Behalf of the Ontario Ministry of Transportation**

**Highway 631 Rehabilitation – GWP 548-00-00  
Culvert Replacement – Mink Lake Culvert  
Station 16+584 - Twp. of Abraham  
Site No. 38C-071**

## **FINAL FOUNDATION INVESTIGATION REPORT**

Date: March 11, 2014  
Ref. N°: 13/03/13042-F2

**Geocres No. 42C-31**

**LVM | MERLEX**

**Submitted To AECOM Canada Ltd.  
189 Wyld Street Suite 103, North Bay, Ontario P1B 1Z2  
On Behalf of the Ontario Ministry of Transportation**

**Highway 631 Rehabilitation – GWP 548-00-00  
Culvert Replacement – Mink Lake Culvert  
Station 16+584 - Twp. of Abraham  
Site No. 38C-071**

## Final Foundation Investigation Report

Prepared by:

---

**Alexander Tepylo, P.Eng.**

LVM | Merlex – Project Engineer

---

**M.A. Merleau, P. Eng.**

LVM | Merlex – Principal Engineer  
MTO Designate

Reviewed by:

---

**Jake Berghamer, P. Eng.**

LVM | Merlex – Regional Manager

## TABLE OF CONTENTS

<b>1 INTRODUCTION .....</b>	<b>1</b>
<b>2 SITE DESCRIPTION .....</b>	<b>1</b>
2.1 Site Physiography and Surficial Geology.....	1
<b>3 INVESTIGATION PROCEDURES .....</b>	<b>1</b>
<b>4 SUBSURFACE CONDITIONS.....</b>	<b>3</b>
4.1 Culvert Station 16+584, Twp of Abraham.....	3
4.1.1 Pavement Structure.....	3
4.1.2 Embankment Fill.....	3
4.1.3 Organic Soils.....	3
4.1.4 Fill.....	4
4.1.5 Sand .....	4
4.1.6 Sand and Silt.....	4
4.1.7 Sand .....	4
4.2 Groundwater Data .....	5

### Appendices

Appendix 1	Key Plan
Appendix 2	Subsurface Data
Appendix 3	Borehole Plan and Lab Data
Appendix 4	Photo Essay

## Property and Confidentiality

"This engineering document is the work and property of LVM inc. and, as such, is protected under Copyright Law. It can only be used for the purposes mentioned herein. Any reproduction or adaptation, whether partial or total, is strictly prohibited without having obtained LVM inc.'s and its client's prior written authorization to do so.

Test results mentioned herein are only valid for the sample(s) stated in this report.

LVM inc.'s subcontractors who may have accomplished work either on site or in laboratory are duly qualified as stated in our Quality Manual's procurement procedure. Should you require any further information, please contact your Project Manager."

Client:

AECOM Canada Ltd.

189 Wyld Street, Suite 103

North Bay, Ontario

P1B 1Z2

Attention: **Mr. Al Rose**

REVISION AND PUBLICATION REGISTER		
Revision N°	Date	Modification And/Or Publication Details
00	2014-01-15	DRAFT Report Issued
01	2014-03-11	Final Report Issued

REPORT DISTRIBUTION	
5 hard copies and 1 electronic copy	MTO Project Manager
1 hard copy and 1 electronic copy	MTO Pavements and Foundations Section, Foundations Group

## 1 INTRODUCTION

LVM | MERLEX has been retained by AECOM Canada Ltd., on behalf of the Ministry of Transportation of Ontario (MTO), to carry out a foundation investigation for the proposed replacement of an existing culvert under GWP 548-00-00. This culvert replacement is located on Highway 631, some 14.3 km north of the Junction with Hwy 17, in the Township of Abraham. The foundation investigation location was specified by the MTO in the RFP/TPM documentation Agreement No. 5011-E-0040. The terms of reference for the scope of work are outlined in LVM | MERLEX's Proposal P-12-140, dated September, 2012. The purpose of this investigation was to determine the subsurface conditions in the area of the culvert in order to provide design recommendations. LVM | MERLEX investigated the foundation area by the drilling of boreholes, carrying out in-situ tests, and performing laboratory testing on select samples.

## 2 SITE DESCRIPTION

The existing Structural Plate Corrugated Steel Pipe (SPCSP) culvert is located on Highway 631 at Station 16+584, Township of Abraham. The terrain in the area of this culvert is a low wet land/forested valley area connecting to Mink Lake to the north. Organic terrain was observed to the south (right) and north (left) of the embankment. The existing highway embankment currently supports two undivided lanes of highway, locally oriented in a west-east direction. The existing highway, at the culvert location, is constructed on an embankment consisting of granular fill mixed with rock fill, some 6.7 m in height, with centerline elevation of 421.7 m at the culvert location. The culvert at this location is a 3.05 m diameter SPCSP culvert, some 29.9 m in length. Flow through the culvert at this site is from right to left (south to north) (see Photo Essay, Appendix 4).

No above ground infrastructure was observed at this site.

### 2.1 SITE PHYSIOGRAPHY AND SURFICIAL GEOLOGY

This project is located in the Geomorphic Sub-province known as the Long Lake Rocky and Limy Drift Uplands. The topography on this section of Highway 631 is generally rolling. At many locations, significant layers of earth overburden cover the bedrock. Organic material was also observed. Within the project area the overburden consists primarily of sands containing varying amounts of silts and gravel.

Bedrock in the area, as indicated on OGS Map 2506, is of the Early Precambrian period. In the area of this culvert foundation investigation, the bedrock comprises of granitic rocks, syenite, pegmatite, and unsubdivided migmatite.

## 3 INVESTIGATION PROCEDURES

The fieldwork for this investigation was carried out during the period between July 21<sup>st</sup> and 23<sup>rd</sup>, 2013 during which time three (3) sampled boreholes were advanced. For the purposes of

foundation design for the culvert replacement, one (1) borehole was advanced at the culvert outlet, one (1) borehole was advanced through the embankment in the area of the culvert, and one (1) borehole was advanced at the culvert inlet.

The field investigation was carried out using a bombardier mounted CME drill rig equipped with hollow stem augers, standard augers, and routine geotechnical sampling equipment. Soil samples were obtained at the borehole locations at regular intervals of depth using the standard 50 mm O.D. split spoon sampler advanced in accordance with the Standard Penetration Test (SPT) procedures (ASTM D-1586). The SPT method involves advancing a 50 mm O.D. split spoon sampler with the force of a 63.5 kg hammer freely dropping 760 mm mounted in a trip (automatic) hammer. The number of blows per 300 mm penetration was recorded as the “N” value. When cohesive deposits were encountered, the in-situ strength was measured using an N size field vane, vane collar, and calibrated torque meter. All samples taken during this investigation were stored in labeled airtight containers for transport to the LVM | Merlex North Bay laboratory for visual examination and select laboratory testing.

Groundwater conditions in the open boreholes were observed during the advancement of, and immediately following, completion of the individual boreholes. All open boreholes were backfilled upon completion with compacted auger cuttings in the general order they were removed and, where necessary, bentonite pellet backfill was added to the boreholes to bring them up to grade. At the borehole advanced through the paved portion of the roadway embankment, the upper portion of the hole was backfilled with an asphalt cold patch to seal the existing asphalt surface.

The field work for this investigation was under the full time direction of a senior member of the LVM | Merlex engineering staff who was responsible for locating the boreholes, clearing the borehole locations of underground services, in-situ sampling and testing operations, logging of the boreholes, labeling and preparation of samples for transport to our North Bay laboratory, plus overall drill supervision. All samples were visually examined in the LVM | Merlex North Bay laboratory for textual classification to confirm the field classification. Laboratory testing of select samples included routine testing for natural moisture contents, particle size analysis, plasticity index (Atterberg Limits), as well as specific gravity. The results of the laboratory testing are presented on the individual Record of Borehole Sheets (Appendix 2), with a summary of results presented on the laboratory sheets in Appendix C (Figures Nos. L-1 to L-5).

The locations of the individual boreholes were determined in the field using highway chainage/stationing (established by others) and offsets relative to highway centerline. The MTO co-ordinates, northing and easting, were then established for the boring locations. Elevations contained in this report are referenced to geodetic datum.

## 4 SUBSURFACE CONDITIONS

Details of the subsurface conditions revealed by the investigation program are presented on the enclosed Record of Borehole Logs (Appendix 2) and on Drawing No. 2 (Appendix 3). It should be noted that the stratigraphic delineations presented on the borehole logs and soil strata plot are the result of non-continuous sampling, response to drilling progress, SPT and Dynamic Cone Penetration Test (DCPT) results, plus field observations at the time of drilling. Typically such boundaries represent transitions from one zone to another and are not an exact demarcation of a specific geological unit. Additional consideration should therefore be given to the fact that subsurface conditions may vary markedly between adjacent boreholes and beyond any specific boring location, and are shown on the drawings for illustration purposes only.

### 4.1 CULVERT STATION 16+584, TWP OF ABRAHAM

A plan and profile illustrating the borehole locations and stratigraphic sequences is provided on Drawing No. 2, Appendix 3. During the course of the exploration program, three (3) sampled boreholes were put down at this site, with Borehole No. 2 advanced through the embankment, and Borehole Nos. 1 and 3 advanced at the culvert ends. At the time of the subsurface investigation, the ground surface elevations at Boreholes Nos. 1 to 3 were recorded at 416.5, 421.6, and 415.1 m, respectively.

#### 4.1.1 Pavement Structure

At surface at Borehole No. 2, a pavement structure consisting of 50 mm of asphalt and 100 mm crushed gravel overlying 50 mm asphalt and 150 mm crushed gravel was penetrated.

#### 4.1.2 Embankment Fill

Underlying the pavement structure base at Borehole No. 2, a layer of fill consisting of brown sand trace silt and varying gravel content was penetrated. The granular fill was mixed with cobble/boulder size rock fill. The natural moisture content measured on samples of this deposit was in the order of 1 to 17%, indicating a dry to wet moisture condition, relative to optimum moisture content. Gradation analyses were carried out on two (2) samples of this deposit, the results of which indicated 15 to 48% gravel size particles, 42 to 80% sand size particles, and 5 to 10% silt and clay size particles (Figure No. L-1, Appendix 3). Based on SPT 'N' values of 4 to 43 blows per 300 mm penetration, the compactness of this deposit was described as loose to dense. This deposit was encountered to a depth of 6.1 m below grade (Elevation 415.5 m).

#### 4.1.3 Organic Soils

At surface at BH No. 3 and underlying the fill at BH No. 2, a deposit of brown silty peat trace gravel, and occasional cobbles was penetrated. The natural moisture content measured on samples of this deposit was in the order of 93 to 266%. This deposit was encountered to depths of 6.9 and 0.6 m below grade at Borehole Nos. 2 and 3, respectively (Elevations 414.7 and 414.5 m, respectively).

At surface, at BH No. 1, a layer of surficial organic soils, some 50 mm thick, was penetrated.

## 4.1.4 Fill

Underlying the surficial organic soils at Borehole No. 1, a deposit of fill described as brown sand trace silt trace gravel was penetrated. Occasional cobble/boulder size rock pieces were encountered in this deposit. The natural moisture content measured on samples of this deposit was in the order of 12%, indicating a moist moisture condition, relative to optimum moisture content. Based on SPT 'N' values of 10 blows per 300 mm penetration, the compactness of this deposit was described as compact. This deposit was encountered to a depth of 0.6 m below grade (Elevation 415.9 m).

## 4.1.5 Sand

Underlying the fill at Borehole No. 1, and underlying the organic soils at Borehole Nos. 2 and 3, a deposit of grey sand trace silt, trace gravel was penetrated. The natural moisture content measured on samples of this deposit was in the order of 17 to 29%, indicating a wet moisture condition, relative to optimum moisture content. Gradation analyses were carried out on five (5) samples of this deposit, the results of which indicated 0 to 10% gravel size particles, 81 to 97% sand size particles, and 3 to 9% silt and clay size particles (Figure No. L-2, Appendix 3). Based on SPT 'N' values of 0 (static weight of hammer) to 10 blows per 300 mm penetration, the compactness of this deposit was described as very loose to loose. This deposit was encountered to depths of 3.7, 8.8, and 2.9 m at Borehole Nos. 1, 2, and 3, respectively (Elevations 412.8, 412.8, and 412.2 m, respectively).

## 4.1.6 Sand and Silt

Underlying the sand at each borehole, a deposit of sand and silt, described as grey sand with silt to grey silt some sand, trace to some gravel was encountered. The natural moisture content measured on samples of this deposit was in the order of 9 to 27%, indicating a wet moisture condition, relative to optimum moisture content. Gradation analyses were carried out on six (6) samples of this deposit, the results of which indicated 0 to 15% gravel size particles, 14 to 72% sand size particles, 26 to 83% silt size particles, and 1 to 3% clay size particles (Figure No. L-3, Appendix 3). Atterberg Limits testing was attempted on samples of this deposit, the results indicated this material is non-plastic. Based on SPT 'N' values of 11 to 27 blows per 300 mm, the compactness of this deposit was described as compact. This deposit was encountered to a depth of 5.5 m below grade at Borehole Nos. 1 and 3 (Elevations 411.0 and 409.6 m, respectively). Sampling was terminated in this deposit at a depth of 12.6 m below grade at Borehole No. 2 (Elevation 409.0 m).

## 4.1.7 Sand

Underlying the sand and silt deposit at Borehole Nos. 1 and 3, a deposit of grey sand trace silt trace to some gravel was penetrated. The natural moisture content measured on samples of this deposit was in the order of 13 to 24%, indicating a wet moisture condition, relative to optimum moisture content. Gradation analyses were carried out on three (3) samples of this deposit, the results of which indicated 8 to 18% gravel size particles, 75 to 87% sand size



particles, and 3 to 7% silt and clay size particles (Figure No. L-4, Appendix 3). Based on SPT 'N' values of 0 (static weight of hammer) to 15 blows per 300 mm penetration, the compactness of this deposit was described as very loose to compact, generally compact. Auger refusal was encountered in this deposit at a depth of 7.7 m at Borehole Nos. 1 (Elevation 408.8 m). Sampling was terminated in this deposit at a depth of 9.6 m below grade at Borehole No. 3 (Elevation 405.5 m).

## **4.2 GROUNDWATER DATA**

The water level at the culvert outlet (left/north side) and inlet (right/south side) was measured between elevations of 415.4 and 415.7 m, respectively, at the time of this investigation.

Measurements of the groundwater level and cave-in levels were undertaken, where possible, in the open boreholes during the advance of the individual borings and upon completion. These levels are recorded on the individual Record of Borehole Log Sheets (Appendix B). The water levels in Borehole Nos. 1 and 3 were measured at elevations 415.6 and 414.9 m upon completion, respectively.

The groundwater and surface water levels will fluctuate seasonally/yearly.

## Appendix 1 Key Plan

Drawing No. 1

Key Plan

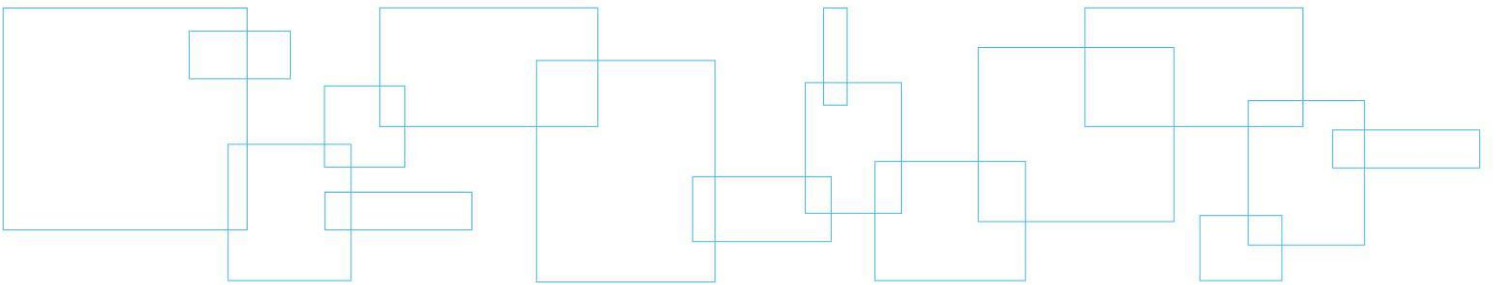

# KEY PLAN

Drawing No. 1

NOT TO SCALE

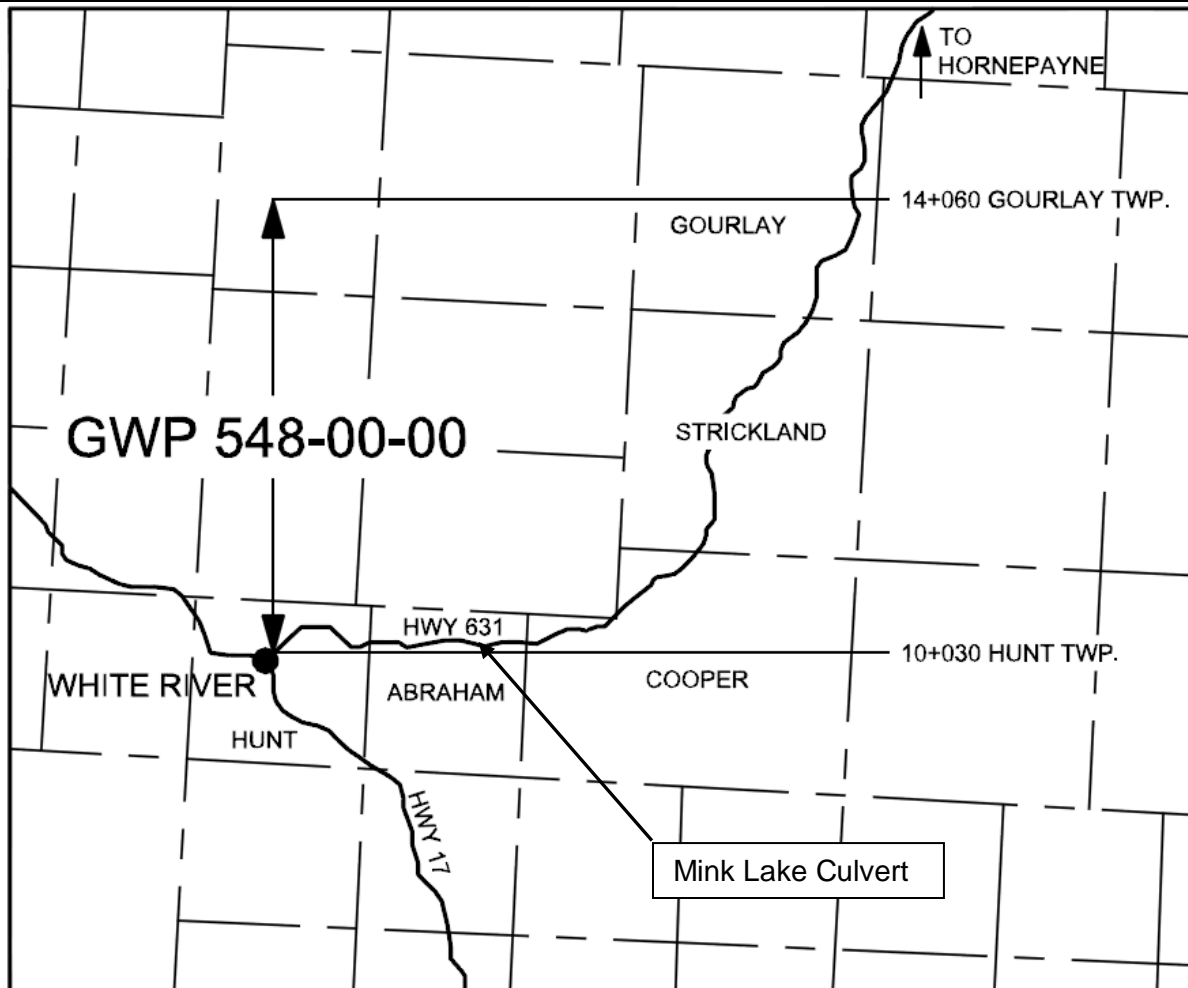

**FINAL**  
**FOUNDATION INVESTIGATION REPORT**  
**GWP 548-00-00**  
Highway 631  
Mink Lake Culvert

**LVM | MERLEX**

Reference No: 13/03/13042-F2

March 2014

## Appendix 2   Subsurface Data

Enclosure No. 1  
Enclosure Nos. 2 to 4

List of Abbreviations and Symbols  
Record of Borehole Sheet

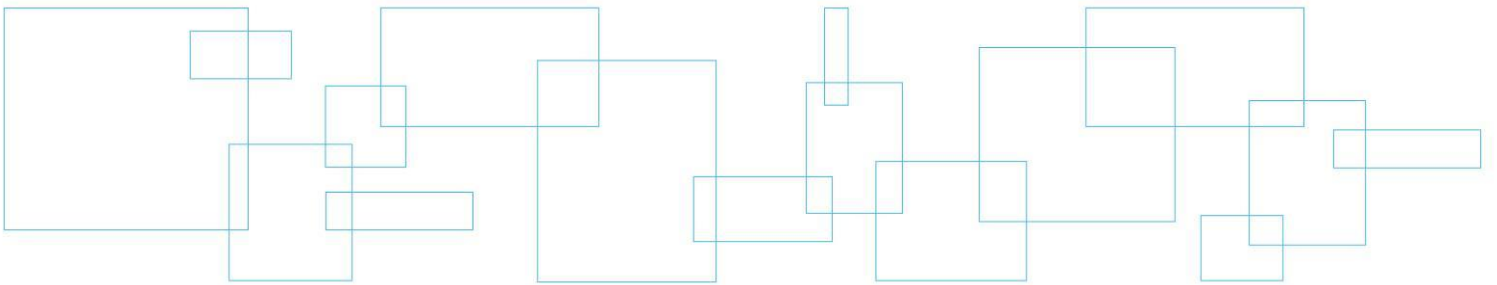

## LIST OF ABBREVIATIONS & DESCRIPTION OF TERMS

The abbreviations and terms, used to describe retrieved samples and commonly employed on the borehole logs, on the figures and in the report are as follows:

### 1. ABBREVIATIONS

AS	Auger Sample
CS	Chunk Sample
DS	Denison type sample
FS	Foil Sample
NFP	No Further Progress
PH	Sampler advanced by hydraulic pressure
PM	Sampler advanced by manual pressure
RC	Rock core with size & percentage of recovery
SS	Split Spoon
ST	Slotted Tube
TO	Thin-walled, open
TP	Thin-walled, piston
WS	Wash Sample
Rec	% recovery from individual run of rock core
RQD	Rock quality designation (%)

### 2. PENETRATION RESISTANCE/"N"

*Dynamic Cone Penetration Test (DCPT):*

A continuous profile showing the number of blows for each 300 mm of penetration of a 50 mm diameter 60° cone attached to AW rod driven by a 63 kg hammer falling 760 mm.

Plotted as —●—●—●—●—

*Standard Penetration Test (SPT) or "N" Values*

The number of blows of a 63 kg hammer falling 760 mm required to advance a 50 mm O.D. drive open sampler 300 mm.

### 3. SOIL DESCRIPTION

a) *Cohesionless Soils:*

"N" (blows/0.3 m)	Relative Density
0 to 4	very loose
4 to 10	loose
10 to 30	compact
30 to 50	dense
over 50	very dense

b) *Cohesive Soils:*

Undrained Shear Strength (kPa)	Consistency
Less than 12	very soft
12 to 25	soft
25 to 50	firm
50 to 100	stiff
100 to 200	very stiff
over 200	hard

### 3. SOIL DESCRIPTION (Cont'd)

c) *Cohesive Soils:*

RQD (%)	Classification
Less than 25	Very poor quality
25 to 50	Poor quality
50 to 75	Fair quality
75 to 90	Good quality
90 to 100	Excellent quality

d) *Method of Determination of Undrained Shear Strength of Cohesive Soils:*

+ 3.2 - Field Vane test in borehole.  
The number denotes the sensitivity to remoulding.

D - Laboratory Vane Test

" - Compression test in laboratory

For a saturated cohesive soil the undrained shear strength is taken as one-half of the undrained compressive strength.

e) *Soil Moisture:*

Moisture	Described as
Dry	Below optimum moisture content
Moist	Near optimum moisture content
Wet	Above optimum moisture content

### 4. TERMINOLOGY

Terminology used for describing soil strata is based on the proportion of individual particle sizes present in the samples (please note that, with the exception of those samples subject to a grain-size analysis, all samples were classified visually and the accuracy of visual examination is not sufficient to determine exact grain sizing):

Trace, or occasional	Less than 10%
Some	10 to 20%
With	20 to 30%
Adjective (i.e. silty or sandy)	30 to 40%
And (i.e. sand and gravel)	40 to 60%

Terminology for cobbles and boulders is based on auger response and field observations:

Occasional	Obstructions encountered in borehole, however advance is not impeded
Numerous	Obstructions are essentially continuous over drilled length

**SAMPLE DESCRIPTION NOTES:**

1. **FILL:** The term fill is used to designate all man-made deposits of natural soil and/or waste materials. The reader is cautioned that fill materials can be very heterogeneous in nature and variable in depth, density and degree of compaction. Fill materials can be expected to contain organics, waste materials, construction materials, shot rock, rip-rap, and/or larger obstructions such as boulders, concrete foundations, slabs, abandoned tanks, etc.; none of which may have been encountered in the borehole. The description of the material penetrated in the borehole therefore may not be applicable as a general description of the fill material on the site as boreholes cannot accurately define the nature of fill material. During the boring and sampling process, retrieved samples may have certain characteristics that identify them as 'fill'. Fill materials (or possible fill materials) will be designated on the Borehole Logs. If fill material is identified on the site, it is highly recommended that testpits be put down to delineate the nature of the fill material. However, even through the use of testpits defining the true nature and composition of the fill material cannot be guaranteed. Fill deposits often contain pockets or seams of organics, organically contaminated soils or other deleterious material that can cause settlement or result in the production of methane gas. It should be noted that the origins and history of fill material is frequently very vague or non-existent. Often fill material may be contaminated beyond environmental guidelines and the material will have to be disposed of at a designated site (i.e. registered landfill). Unless requested or stated otherwise in this report, fill material on this site has not been tested for contaminants however, environmental testing of the fill material can be carried out at your request. Detection of underground storage tanks cannot be determined with conventional geotechnical procedures.
2. **TILL:** The term till indicates a material that is an unstratified, glacial deposit, heterogeneous in nature and, as such, may consist of mixtures and pockets of clay, silt, sand, gravel, cobbles and/or boulders. These heterogeneous deposits originate from a geological process associated with glaciation. It must be noted that due to the highly heterogeneous nature of till deposits, the description of the deposit on the borehole log may only be applicable to a very limited area and therefore, caution must be exercised when dealing with a till deposit. When excavating in till, contractors may encounter cobbles/boulders or possibly bedrock even if they are not indicated on the borehole logs. It must be appreciated that conventional geotechnical sampling equipment does not identify the nature or size of any obstruction.
3. **BEDROCK:** Auger refusal may be due to the presence of bedrock, but possibly could also be due to the presence of very dense underlying deposits, boulders or other large obstructions. Auger refusal is defined as the point at which an auger can no longer be practically advanced. It must be appreciated that conventional geotechnical sampling equipment does not differentiate between nature and size of obstructions that prevent further penetration of the boring below grade. Bedrock indicated on the borehole logs will be labeled 'possibly' or 'probable' etc. based on the response of the boring and sampling equipment, surrounding topography, etc. Bedrock can be proven at individual borehole locations, at your request, by diamond core drilling operations or, possibly, by testpits. It must also be appreciated that bedrock surfaces can be, and most times are, very erratic in nature (i.e. sheer drops, isolated rock knobs, etc.) and caution must be used when interpreting subsurface conditions between boreholes. A bedrock profile can be more accurately estimated, at the clients' request, through a series of closely positioned unsampled auger probes combined with core drilling.
4. **GROUNDWATER:** Although the groundwater table may have been encountered during this investigation and the elevation noted in the report and/or on the record of boreholes, it must be appreciated that the elevation of the groundwater table will fluctuate based upon seasonal conditions, localized changes, erratic changes in the underlying soil profile between boreholes, underlying soil layers with highly variable permeabilities, etc. These conditions may affect the design and type and nature of dewatering procedures. Cave-in levels recorded in borings give a general indication of the groundwater level in cohesionless soils however, it must be noted that cave-in levels may also be due to the relative density of the deposit, drilling operations etc.

**METRIC**

# RECORD OF BOREHOLE NO. 1



REFERENCE	13/03/13042-F2	DATUM	Geodetic	LOCATION	N 5386243.0 E 223342.9 - Abraham Township - Mink Lake Culvert	ORIGINATED BY	JL
PROJECT	GWP 548-00-00, Highway 631			BOREHOLE TYPE	Track Mounted CME 45B - Hollow Stem Augers	COMPILED BY	MCM
CLIENT	AECOM	DATE (Started)	2013 July 21	TIME		CHECKED BY	MAM
		DATE (Completed)	2013 July 21	(Completed)	1:30:00 PM		

SOIL PROFILE			SAMPLES			GROUND WATER CONDITIONS	ELEVATION SCALE	DYNAMIC CONE PENETRATION RESISTANCE PLOT					PLASTIC LIMIT W <sub>p</sub>	NATURAL MOISTURE CONTENT W	LIQUID LIMIT W <sub>L</sub>	UNIT WEIGHT γ kN/m <sup>3</sup>	REMARKS & GRAIN SIZE DISTRIBUTION (%) GR SA (SI CL)			
ELEV DEPTH	DESCRIPTION	STRATA PLOT	NUMBER	TYPE	"N" VALUES			SHEAR STRENGTH kPa										WATER CONTENT (%)		
								○ UNCONFINED		+ FIELD VANE		● QUICK TRIAXIAL						× LAB VANE		
416.5	Ground Surface						20	40	60	80	100	20	40	60						
0.0	50 mm Forest Root Mat		1	SS	10		416						○				0 97 (3)			
415.9	FILL - sand trace silt trace gravel occasional cobbles/boulders brown, moist						415							○						
0.6	(loose) SAND - trace silt trace gravel  brown, wet  (very loose/loose)		2	SS	8		414							○						
							413							○						
			3	SS	2		412							○						
							411													
	grey		4	SS	WH		410							○						
							409													
			5	SS	1															
412.8																				
3.7	SAND AND SILT  grey, wet  (compact)		6	SS	12		416							○			2 72 (26)			
							415													
							414							○						
							413													
			7	SS	12		412							○						
							411													
							410							○						
							409													
			8	SS	WH															
411.0																				
5.5	SAND - trace silt some gravel  grey, wet  (very loose)						416							○			13 84 (3)			
							415													
							414													
							413													
							412													
							411													
							410													
							409													
			9	SS	25/50- mm															
408.8																				
7.7	Auger Refusal End of Borehole						416							○						
							415													
							414													
							413													
							412													
							411													
							410													
							409													
COMMENTS							+ <sup>3</sup> , × <sup>3</sup> : Numbers on right refer to Sensitivity Numbers on left refer to values greater than 120 kPa  ○ 3% STRAIN AT FAILURE					WATER LEVEL RECORDS								
												Date (dd/mm/yyyy/Time)		Water Depth (m)		Cave In (m)				
												1) 13/7/21 1:30:00 PM		0.9		▽ 1.8				
												2)		-		▽ -				
												3)		-		▽ -				
The stratification lines represent approximate boundaries. The transition may be gradual																				

MEL-GEO 13042 - BOREHOLE LOGS - SITE B.GPJ MEL-GEO.GDT 14/3/11

## METRIC

## RECORD OF BOREHOLE NO. 2



REFERENCE 13/03/13042-F2 DATUM Geodetic LOCATION N 5386258.3 E 223338.3 - Abraham Township - Mink Lake Culvert ORIGINATED BY JL  
 PROJECT GWP 548-00-00, Highway 631 BOREHOLE TYPE Track Mounted CME 45B - Hollow Stem Augers COMPILED BY MCM  
 CLIENT AECOM DATE (Started) 2013 July 22 TIME   
 DATE (Completed) 2013 July 23 (Completed) 5:00:00 PM CHECKED BY MAM

SOIL PROFILE			SAMPLES			GROUND WATER CONDITIONS	ELEVATION SCALE	DYNAMIC CONE PENETRATION RESISTANCE PLOT  SHEAR STRENGTH kPa ○ UNCONFINED + FIELD VANE ● QUICK TRIAXIAL × LAB VANE	PLASTIC LIMIT NATURAL MOISTURE CONTENT LIQUID LIMIT W <sub>p</sub> W W <sub>L</sub> WATER CONTENT (%)	UNIT WEIGHT γ kN/m <sup>3</sup>	REMARKS & GRAIN SIZE DISTRIBUTION (%) GR SA (SI CL)
ELEV DEPTH	DESCRIPTION	STRATA PLOT	NUMBER	TYPE	"N" VALUES						
421.6	Asphalt Surface										
0.0	50 mm Asphalt 100 mm Crushed Gravel 50 mm Asphalt 150 mm Crushed Gravel		1	AS							
	FILL - sand trace silt varying gravel content, mixed with cobble/boulder size rock fill		2	SS	43						48 42 (10)
	brown, dry										
	(loose/dense)		3	SS	33						
			4	SS	43						
			5	SS	50/75 mm						
			6	SS	18						15 80 (5)
	wet		7	SS	4						
			8	SS	12						
415.5	PEAT - silty peat trace gravel		9	SS	1						
6.1	brown										
414.7	SAND - trace silt trace gravel		10	SS	10						
6.9	grey, wet										
	(loose/compact)		11	SS	8						10 81 (9)
412.8	SAND AND SILT										
8.8	grey, moist		12	SS	19						15 50 34 1
	(compact)										
Continued Next Page											
COMMENTS								+ 3, × 3 : Numbers on right refer to Sensitivity Numbers on left refer to values greater than 120 kPa ○ 3% STRAIN AT FAILURE			
								WATER LEVEL RECORDS Date (dd/mm/yy)/Time 1) 13/7/23 5:00:00 PM 2) 3)			
The stratification lines represent approximate boundaries. The transition may be gradual.											

MEL-GEO 13042 - BOREHOLE LOGS - SITE B.GPJ MEL-GEO.GDT 14/3/11





**METRIC**

## RECORD OF BOREHOLE NO. 2



REFERENCE	<u>13/03/13042-F2</u>	DATUM	<u>Geodetic</u>	LOCATION	<u>N 5386258.3 E 223338.3 - Abraham Township - Mink Lake Culvert</u>	ORIGINATED BY	<u>JL</u>
PROJECT	<u>GWP 548-00-00, Highway 631</u>			BOREHOLE TYPE	<u>Track Mounted CME 45B - Hollow Stem Augers</u>	COMPILED BY	<u>MCM</u>
CLIENT	<u>AECOM</u>	DATE (Started)	<u>2013 July 22</u>	TIME		CHECKED BY	<u>MAM</u>
		DATE (Completed)	<u>2013 July 23</u>	(Completed)	<u>5:00:00 PM</u>		

[illegible]

## METRIC

## RECORD OF BOREHOLE NO. 3



REFERENCE 13/03/13042-F2 DATUM Geodetic LOCATION N 5386279.0 E 223336.5 - Abraham Township - Mink Lake Culvert ORIGINATED BY JL  
 PROJECT GWP 548-00-00, Highway 631 BOREHOLE TYPE Track Mounted CME 45B - Hollow Stem Augers COMPILED BY MCM  
 CLIENT AECOM DATE (Started) 2013 July 21 TIME   
 DATE (Completed) 2013 July 21 (Completed) 4:50:00 PM CHECKED BY MAM

SOIL PROFILE			SAMPLES			GROUND WATER CONDITIONS	ELEVATION SCALE	DYNAMIC CONE PENETRATION RESISTANCE PLOT  SHEAR STRENGTH kPa ○ UNCONFINED + FIELD VANE ● QUICK TRIAXIAL × LAB VANE	PLASTIC LIMIT NATURAL MOISTURE CONTENT LIQUID LIMIT W <sub>p</sub> W W <sub>L</sub> WATER CONTENT (%)	UNIT WEIGHT γ kN/m <sup>3</sup>	REMARKS & GRAIN SIZE DISTRIBUTION (%) GR SA (SI CL)						
ELEV DEPTH	DESCRIPTION	STRATA PLOT	NUMBER	TYPE	"N" VALUES												
415.1	Ground Surface																
0.0	PEAT - silty peat with rootlets occasional cobbles		1	SS	2		415			266							
414.5	brown																
0.6	SAND - trace silt trace gravel		2	SS	4		414				5 90 (5)						
	grey, wet																
	(very loose/compact)		3	SS	5		413										
			4	SS	5		412				4 92 (4)						
412.2	SAND AND SILT																
2.9	grey, wet		5	SS	7		411										
	(loose)																
			6	SS	2		410				0 14 83 3						
			7	SS	7		409										
409.6	SAND - trace silt trace to some gravel																
5.5	grey, wet		8	SS	11		408				18 75 (7)						
	(compact)																
			9	SS	13		407										
			10	SS	15		406				8 87 (5)						
405.5	End of Sampling																
9.6	End of Borehole																
COMMENTS  The stratification lines represent approximate boundaries. The transition may be gradual.								+ 3, × 3 : Numbers on right refer to Sensitivity Numbers on left refer to values greater than 120 kPa ○ 3% STRAIN AT FAILURE				WATER LEVEL RECORDS Date (dd/mm/yy)/Time 1) 13/7/21 4:50:00 PM 2) 3)		Water Depth (m) 0.2 - -		Cave In (m) 1.3 - -	

MEL-GEO 13042 - BOREHOLE LOGS - SITE B.GPJ MEL-GEO.GDT 14/3/11



## Appendix 3    Borehole Plan and Lab Data

Drawing No. 2:            Borehole Location and Soil Strata  
Figure Nos. L-1 to L-4:    Grain Size Distribution Curves  
Figure No. L-5:            Lab Test Summary Sheet

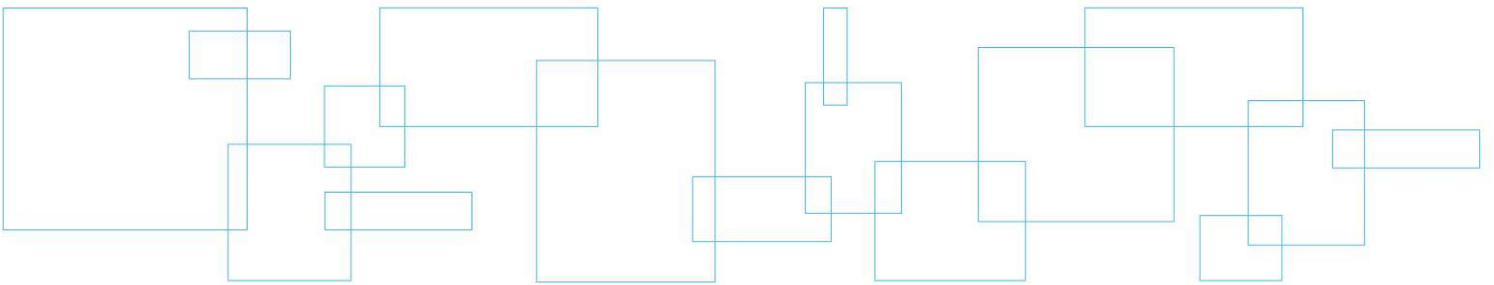

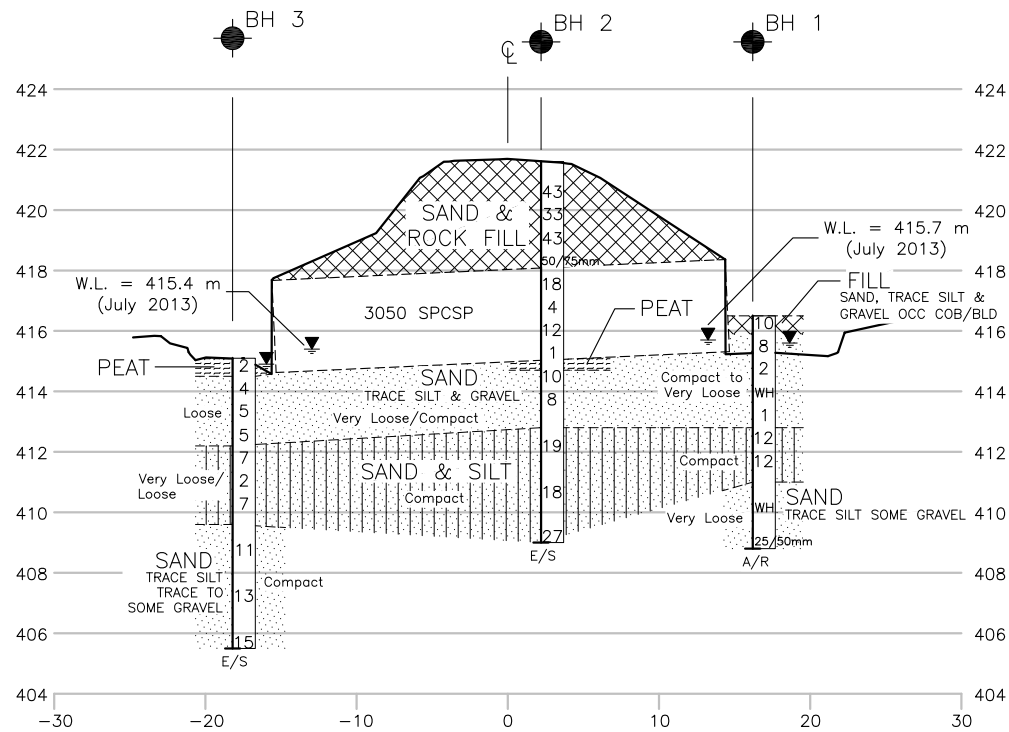
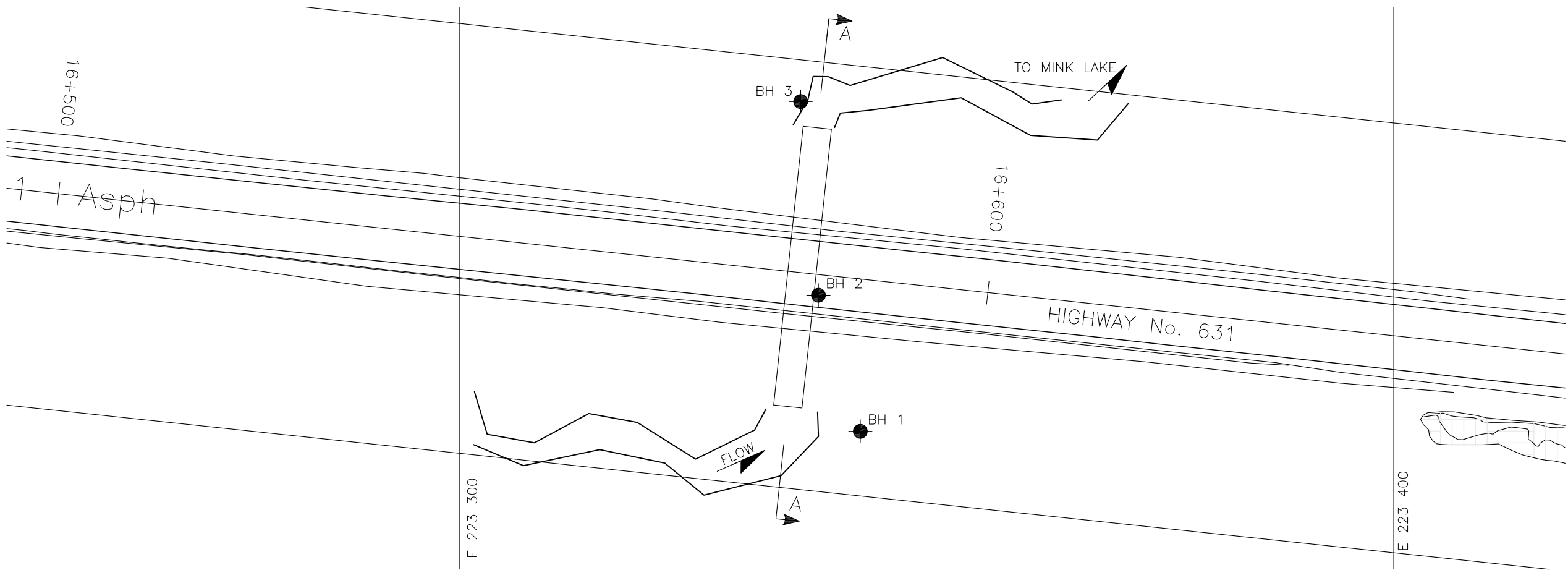

CONT. No.  
XXXX-XXXX

GWP. No.  
548-00-00

N  
DRAWING  
2

HWY 631  
MINK LAKE CULVERT (SITE 38C-071)  
ABRAHAM TOWNSHIP  
BOREHOLE LOCATIONS & SOIL STRATA

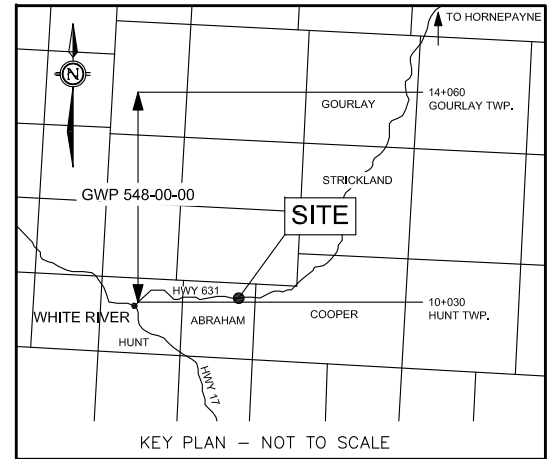

LEGEND

- Borehole
- N Blows/0.3 m (Std Pen Test, 475 J/blow)
- CONE Blows/0.3 m (60° Cone, 475 J/blow)
- Water Level at Time of Investigation
- A/R Auger Refusal at Elevation
- E/S End of Sampling

Borehole No.	Elev.	O/S	Co-ordinates	
			Northerly	Easterly
Borehole No. 1	416.5	16.2 m Rt	5386243.0	223342.9
Borehole No. 2	421.6	2.2 m Rt	5386258.3	223338.3
Borehole No. 3	415.1	18.2 m Lt	5386279.0	223336.5

NOTE 1: This drawing is for subsurface information only. Surface details and features are for conceptual illustration. The proposed structure location is shown for illustration purposes only and may not be consistent with the final design configuration as shown elsewhere in the Contract Documents.

NOTE 2: The boundaries between soil strata have been established at the borehole locations only. The boundaries illustrated and stratigraphy between boreholes on this drawing are assumed based on borehole data and may vary. They are intended for design only.

REVISIONS	DATE	BY	DESCRIPTION
	FEB 2014	RG	Revisions for Final, Add GEOCRETS #
HWY NO. 631 - ABRAHAM TOWNSHIP			
GEOCRETS NO.: 42C-31			
L/V/M REFERENCE NO.: 13/13/13042			
DRAWN: RG		CHECKED: AT	DATE: NOVEMBER 2013

# GRAIN SIZE ANALYSIS

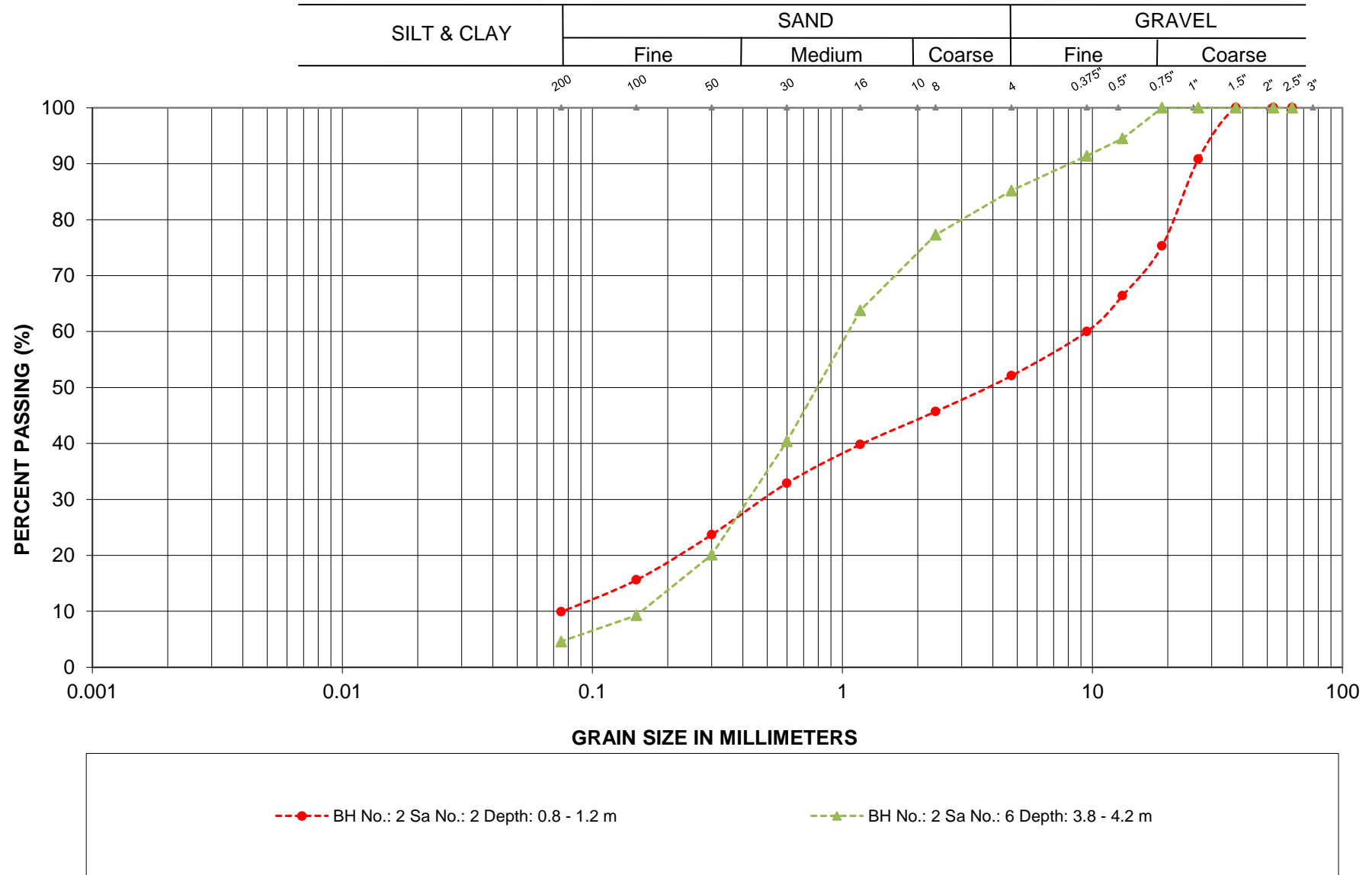

G.W.P.: 548-00-00  
LOCATION: Hwy 631, Mink Lake Culvert

EMBANKMENT FILL

LVM | MERLEX

FIGURE L-1

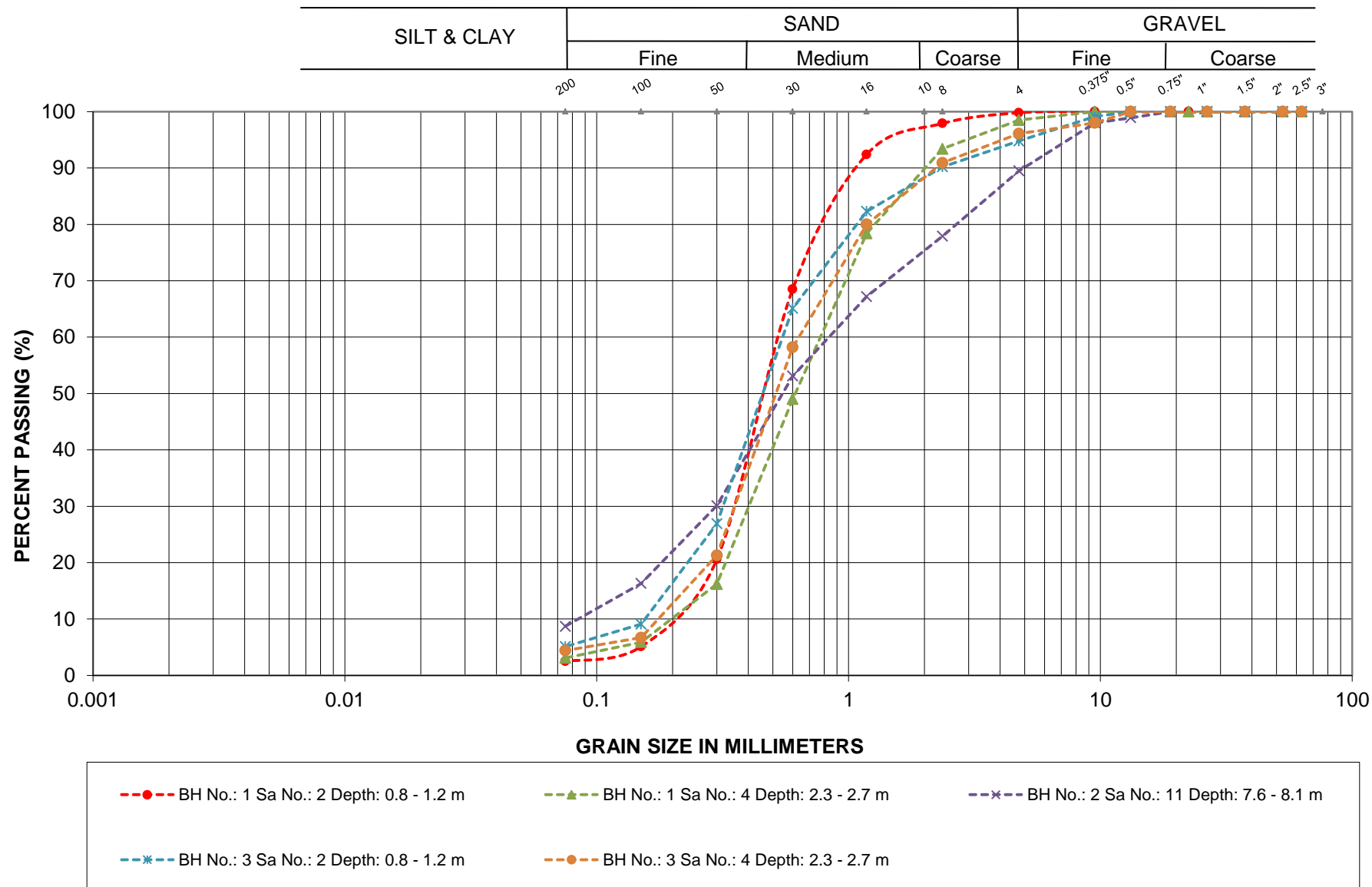
**GRAIN SIZE ANALYSIS**

G.W.P.: 548-00-00

LOCATION: Hwy 631, Mink Lake Culvert

SAND

LVM | MERLEX

FIGURE L-2

## GRAIN SIZE ANALYSIS

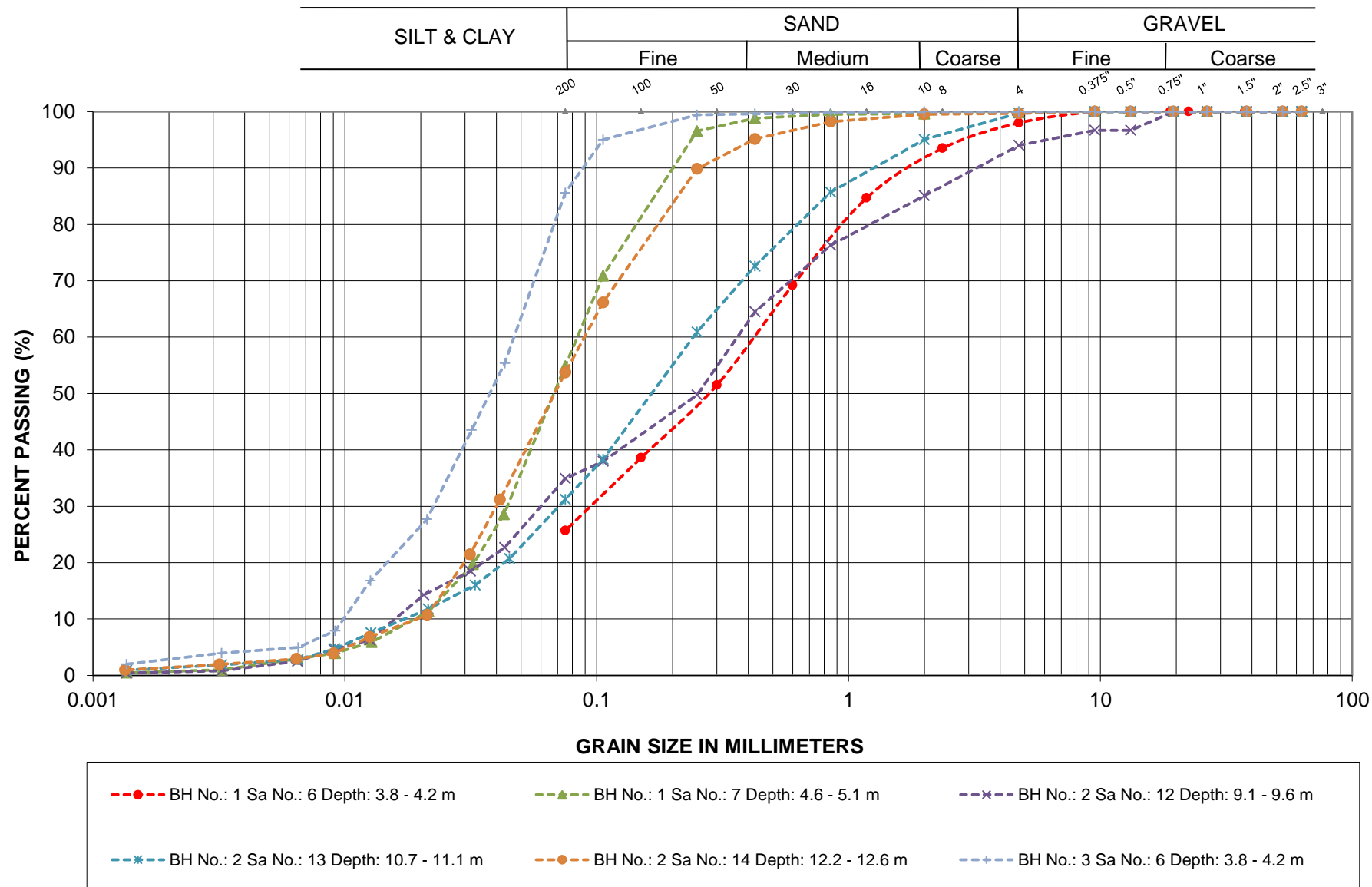

G.W.P.: 548-00-00

LOCATION: Hwy 631, Mink Lake Culvert

SAND AND SILT

LVM | MERLEX

FIGURE L-3

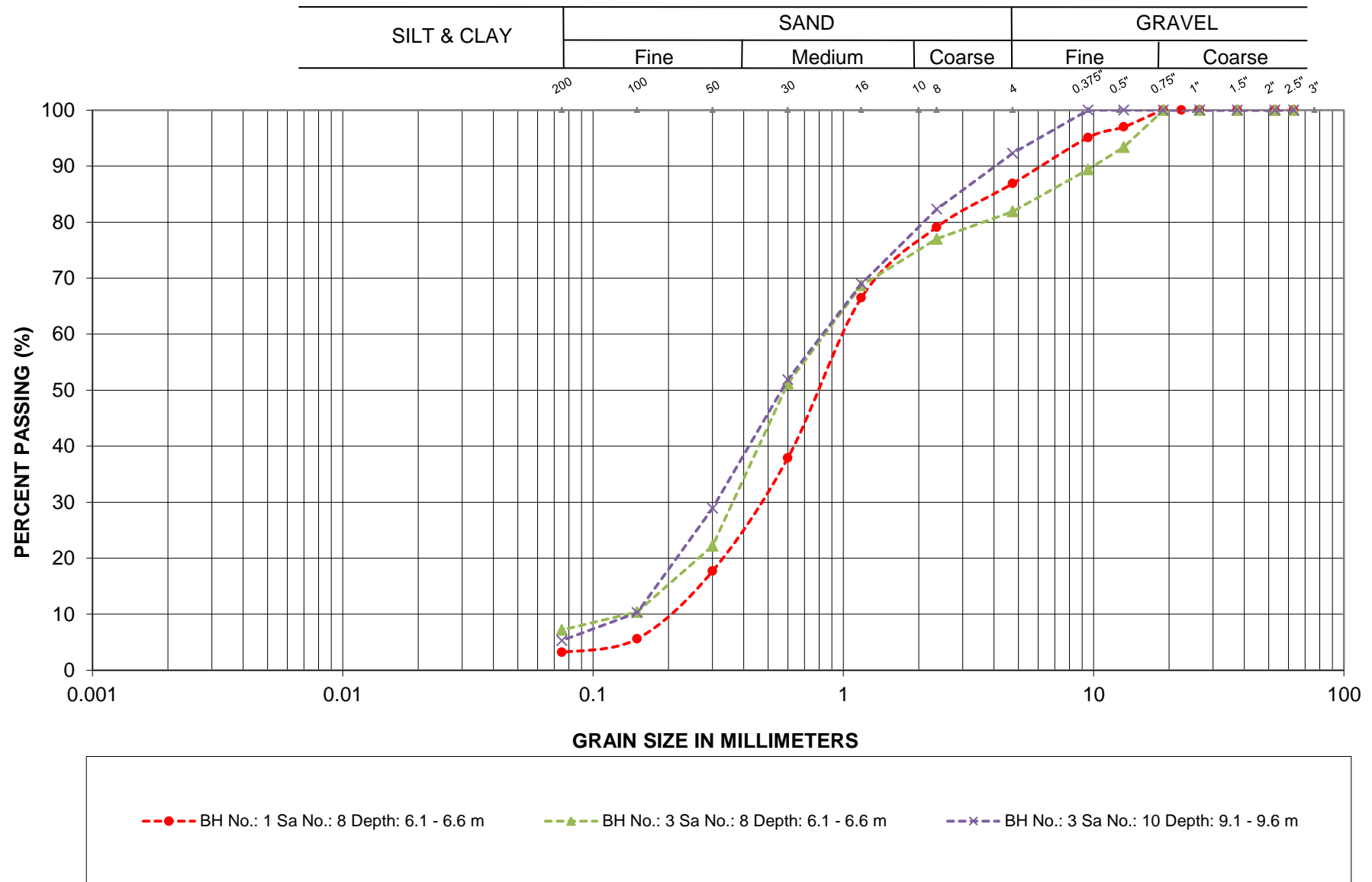
**GRAIN SIZE ANALYSIS**

G.W.P.: 548-00-00

LOCATION: Hwy 631, Mink Lake Culvert

SAND



## Laboratory Tests - Summary Sheet

Borehole No.	Sample No.	Depth	Grain Size Analysis				NMC	Atterberg Limits			SPT 'N'	USCS	Unit Weight (kN/m3)	Remarks
			Gravel Size (%)	Sand Size (%)	Silt Size (%)	Clay Size (%)		LL (%)	PL (%)	IP (%)				
1	1	0.0					11.5				10			
	2	0.8	0	97	3		25.8				8			
	3	1.5					27.5				2			
	4	2.3	1	96	3		29.9				WH			
	5	3.0					21.4				1			
	6	3.8	2	72	26		26.1				12			
	7	4.6	0	45	54	1	16.8				12			
	8	6.1	13	84	3		24.2				WH			
	9	7.6					11.7				25/50 mm			
2	1	0.0					3.7							
	2	0.8	48	42	10		2.7				43			
	3	1.5					5.4				33			
	4	2.3					0.7				43			
	5	3.0					1.2				50/75 mm			
	6	3.8	15	80	5		11.3				18			
	7	4.6					16.9				4			
	8	5.3									12			
	9	6.1					93.0				1			
	10	6.9					23.4				10			
	11	7.6	10	81	9		18.5				8			
	12	9.1	15	50	34	1	9.0				19			
	13	10.7	5	64	29	2	14.9				18			
	14	12.2	0	46	51	2	18.7				27			
3	1	0.0					265.6				2			
	2	0.8	5	90	5		26.9				4			

## Laboratory Tests - Summary Sheet

[illegible]

## Appendix 4 Photo Essay

Enclosure No. 5:

Photo Essay

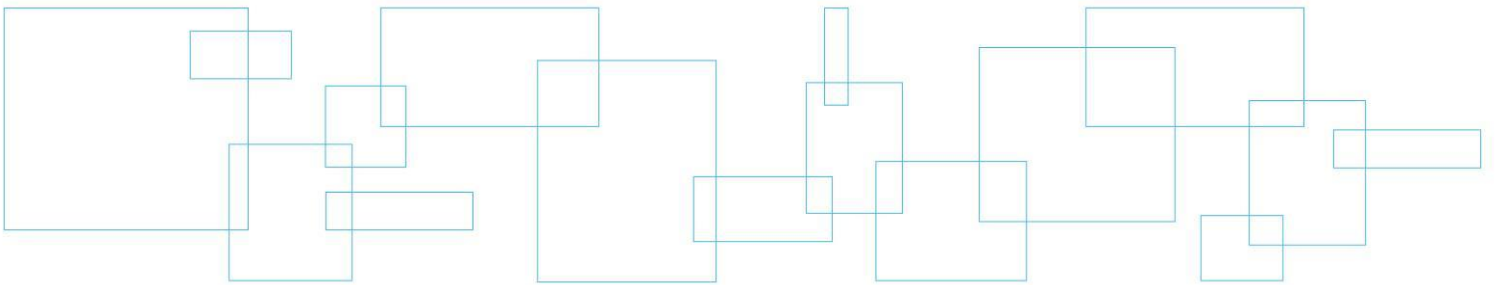

Culvert Outlet – Looking North

Photo: 1



Embankment at Outlet – Looking South

Photo: 2



Project: Hwy 631 – Mink Lake Culvert

Photos Provided By: LVM

Date: June 2013



Culvert Inlet – Looking South

Photo: 3



South (Right) side of Embankment – Looking West

Photo: 4



Project: Hwy 631 – Mink Lake Culvert

Photos Provided By: LVM

Date: June 2013

View Through Culvert – Looking South

Photo: 5



Project: Hwy 631 – Mink Lake Culvert

Photos Provided By: LVM

Date: June 2013